

WHISKY

Fase¹



BRAVO
OSCAR
TANGO
WHISKEY



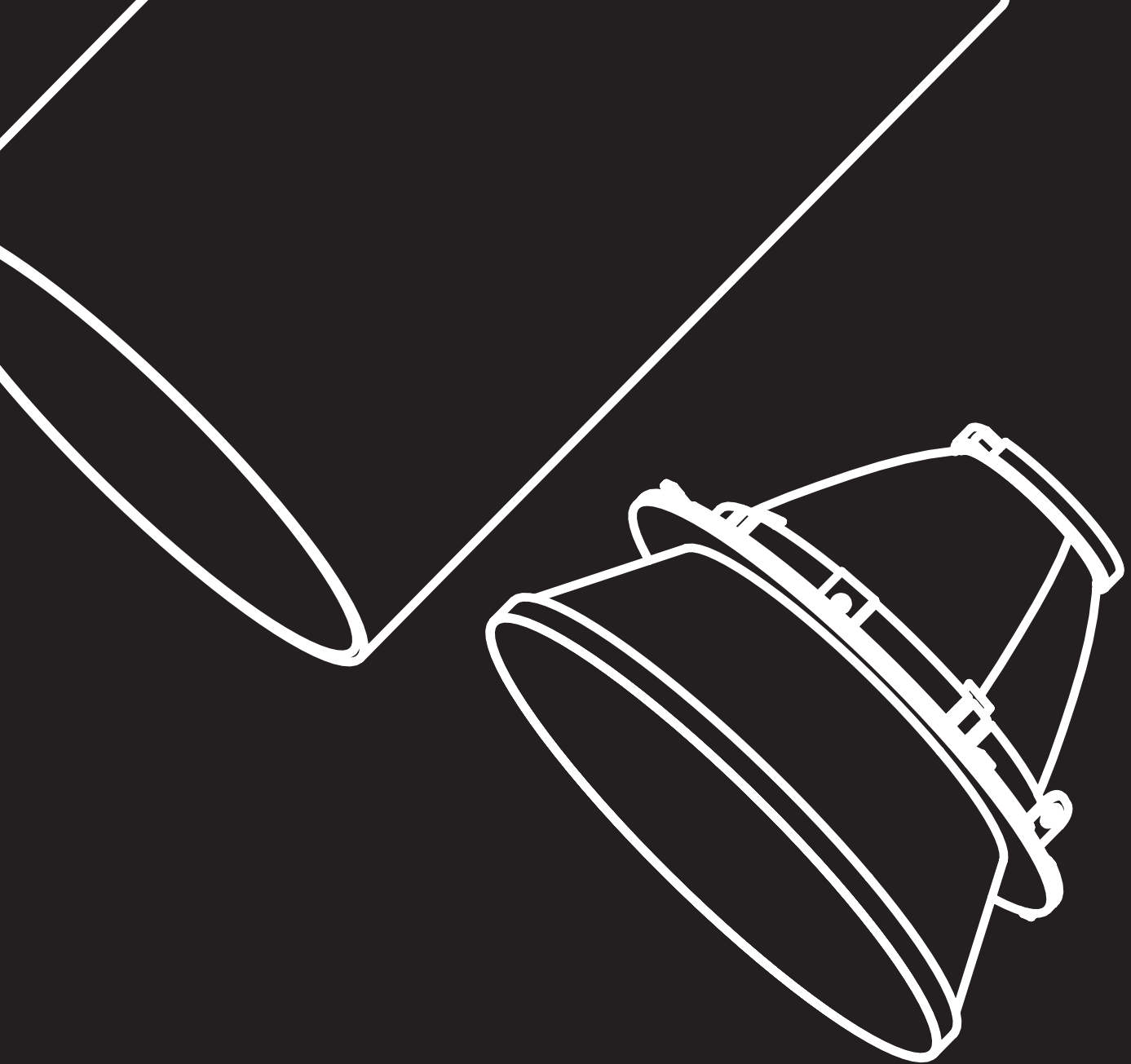

WHISKEY KEY

Introducing

THE WHISKEY

Whiskey is a modular lighting system, ornate yet simplistic in nature. The tubular-minimalistic design is seamless and will illuminate any commercial setup. It offers 2.5" and 4.5" diameter apertures with wattages up to 26W.

The architectural cylinders are made with solid extruded aluminium and are available in a suspension, surface and wall mount application, making it a versatile addition to multiple settings. The collection has a sleek and clean finish with a minimalistic approach, making this collection trendy and extremely adaptable for your space.

Its time to get Whiskey'd away.



MOUNT STYLES

Whiskey offers three mounting options for ease of installation with chic style. The first is a suspension option followed by the widely anticipated surface mount which provides exemplary style. This modern take will elevate your space without having to impose invasive installation practices.

The third is a wall mount application that provides just the right amount of illumination as ambience lighting for spaces like vanity areas or corridors. Choose between these flexible mounting styles to create a cohesive interior design.



LIGHT CHOICE

Each Whiskey module sports a seamless, solid, extruded aluminum body that makes this versatile collection suitable for multiple décor styles. Built to last, choose between three different heights and mounting options to meet your every need.



SUSPENSION

The suspension module, as the more decorative piece of this collection, works just like a hanging pendant but incorporates a sleeker and more compact style. With its seamless design and minimalistic approach, you can creatively light up any space.



All housing available in white and black

LAMPING		
Wattage:	13W	26W
Source:	Integrated LED	Integrated LED
Beam angle:	15°/24°/38°	15°/24°/38°
Kelvin:	2700K/3000K/3500K/4000K	2700K/3000K/3500K/4000K
Lumens:	1260lm	2030lm
CRI:	90+	90+
Dimming:	0-10V/ELV/Triac	0-10V/ELV/Triac
Location:	Damp	Damp
Input:	120-277V (347 upon request)	120-277V (347 upon request)
Color:	Black/White	Black/White
Type:	Slim/Broad	Broad

SPECIFICATION DRAWINGS

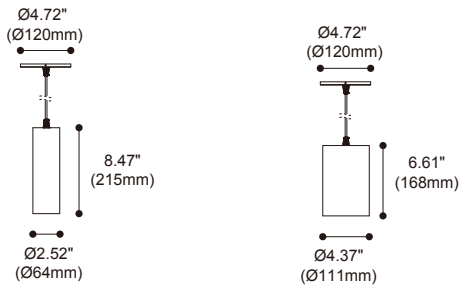

13W WIDE

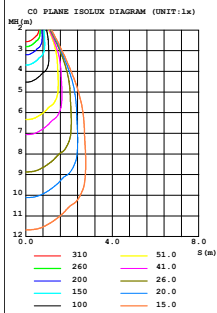
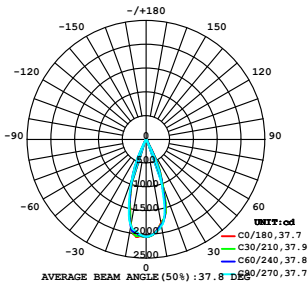

26W WIDE

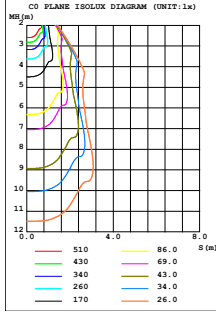
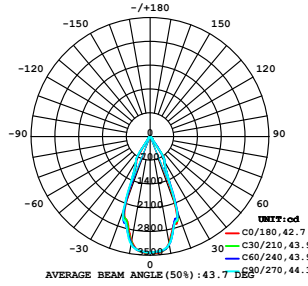

** See pg 28 for full photometrics
*** For customization, please consult Eurofase



SURFACE

For this module, the light fixture is mounted to the ready-to-install plate that is attached to the ceiling. It works perfectly in spaces with drop down, exposed, and structural ceilings. It includes a reflector that allows three kinds of light flow: spot, flood, and wide flood which allows you to illuminate your space as required. Also offered in a broad and a slim version.



All housing available in white and black

LAMPING		
Wattage:	13W	26W
Source:	Integrated LED	Integrated LED
Beam angle:	15°/24°/38°	15°/24°/38°
Kelvin:	2700K/3000K/3500K/4000K	2700K/3000K/3500K/4000K
Lumens:	1260lm	2030lm
CRI:	90+	90+
Dimming:	0-10V/ELV/Triac	0-10V/ELV/Triac
Location:	Damp	Damp
Input:	120-277V (347 upon request)	120-277V (347 upon request)
Color:	Black/White	Black/White
Type:	Slim/Broad	Broad

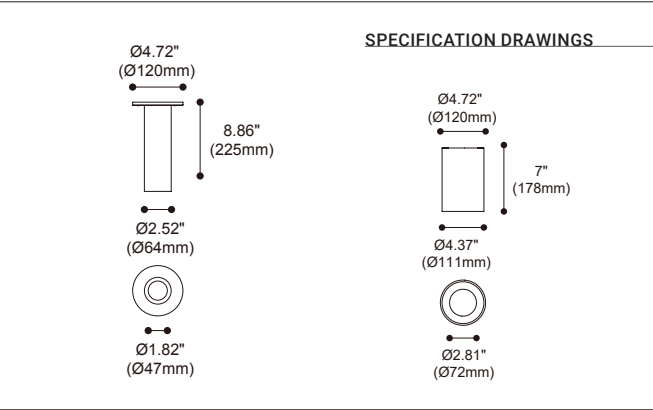

13W WIDE

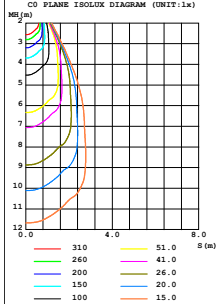
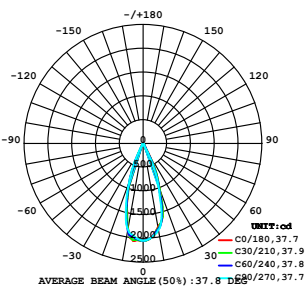

26W WIDE

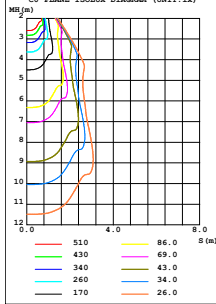
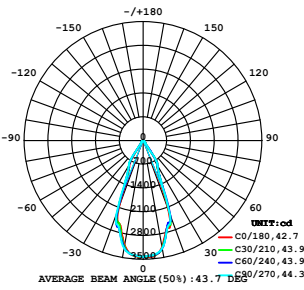

** See pg 28 for full photometrics
*** For customization, please consult Eurofase

WALL

This module as a whole can be attached to the wall and protrudes outwards from its surface. This too can work as a decorative piece of the collection and be used to elevate the space, adding drama and illuminating brilliance. The clean look of the wall mount, with easy installation, makes it a contemporary and functional piece.



All housing available in white and black

LAMPING

Wattage:	13W	26W
Source:	Integrated LED	Integrated LED
Beam angle:	15°/24°/38°	15°/24°/38°
Kelvin:	2700K/3000K/3500K/4000K	2700K/3000K/3500K/4000K
Lumens:	1260lm	2030lm
CRI:	90+	90+
Dimming:	0-10V/ELV/Triac	0-10V/ELV/Triac
Location:	Damp	Damp
Input:	120-277V (347 upon request)	120-277V (347 upon request)
Color:	Black/White	Black/White
Type:	Slim/Broad	Broad

SPECIFICATION DRAWINGS

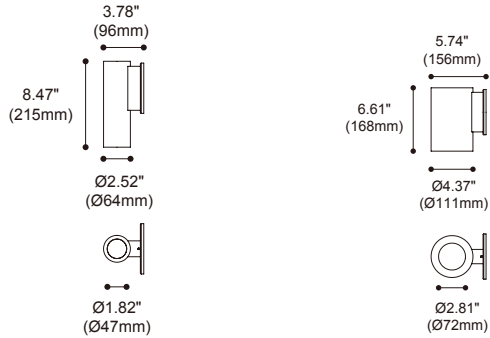

13W WIDE

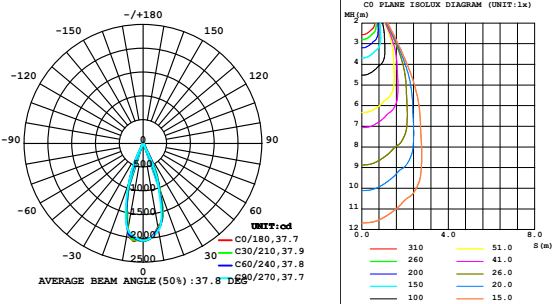

26W WIDE

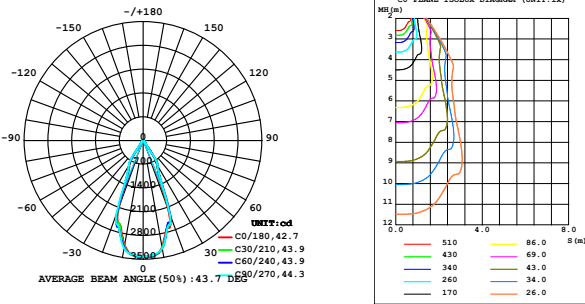

** See pg 29 for full photometrics
*** For customization, please consult Eurofase



01

ACCESSORIES

OPTIC REFLECTORS: Beam Angle

Spot	Narrow 15°
Flood	Medium 24°
Wide Flood	Wide 38°



Reflectors installed into the light engine, before the diffusers

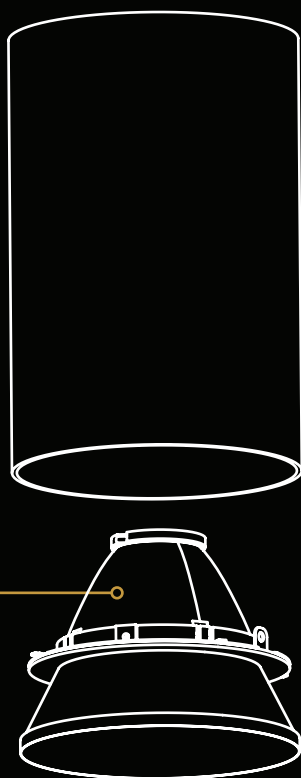

02

BAFFLE: Finishes

Black
White
Chrome
Gold

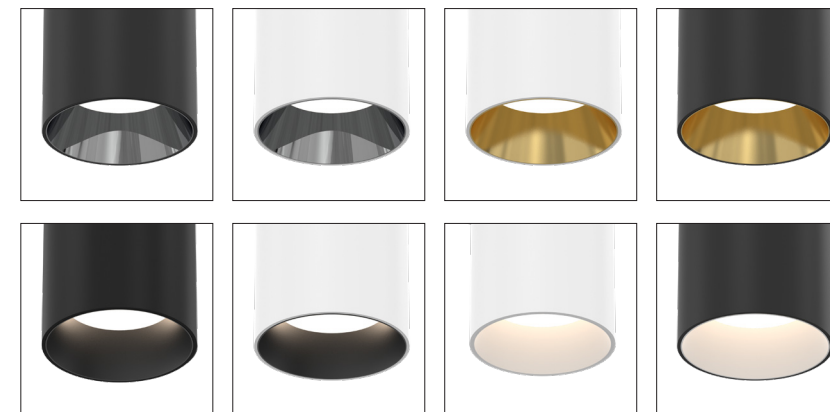

03

LENS: Diffuser

Standard Lens (INCLUDED)
Clear glass protective lens

Dichroic Lens
Accurately filter colors to change room ambiance (Orange/Red/Blue/Green)

Spread Lens
Wider beam diffuser to focus on larger objects

Linear Spread Lens
Oval flood beam best suited for wall washing applications

Frosted Lens
Disperses light evenly with a soft, diffused glow

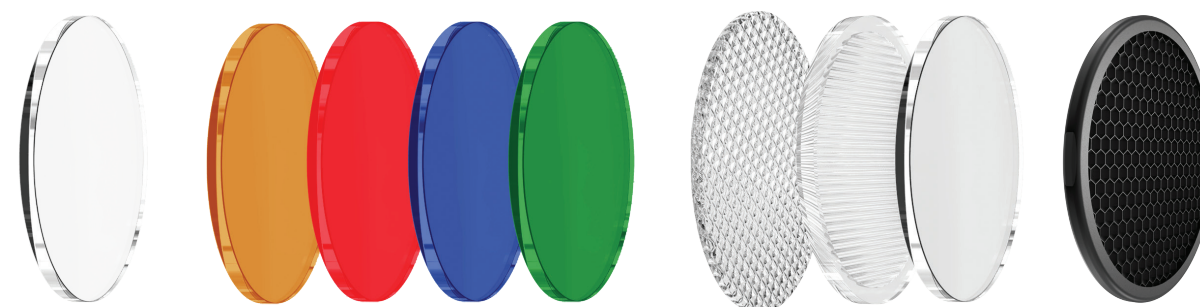

LASTING IMPRESSION

The Whiskey collection are UL Listed to ensure safe operation for many years to come. We want to ensure your success with every project you tackle. We're also offering a 5 year limited warranty.



DIMENSION DRAWINGS

SUSPENSION

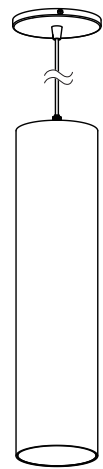

SURFACE

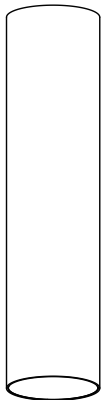

WALL

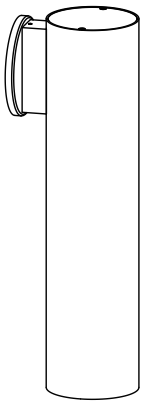

SURFACE MOUNT

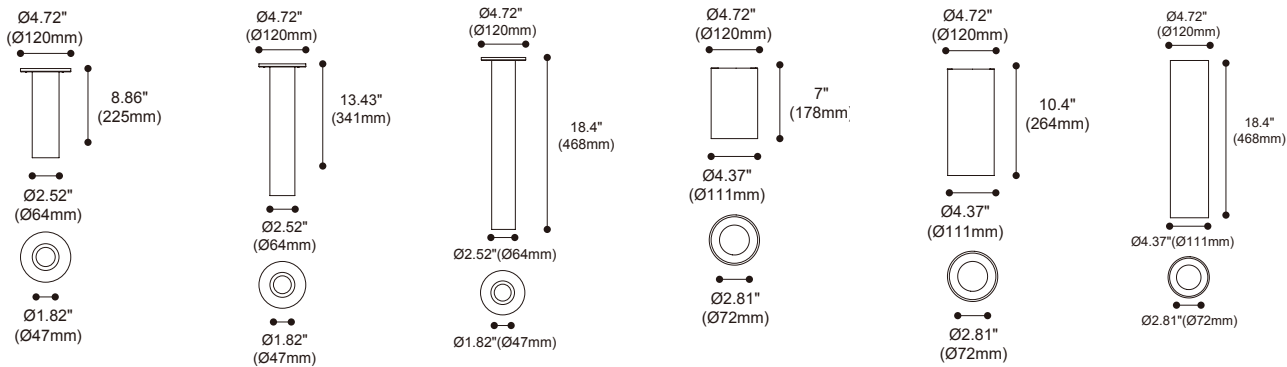

SUSPENSION

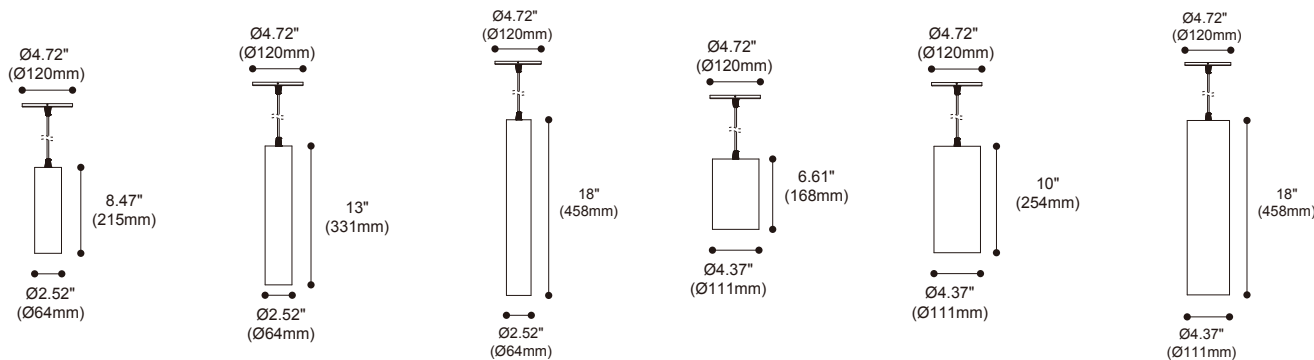

WALL MOUNT

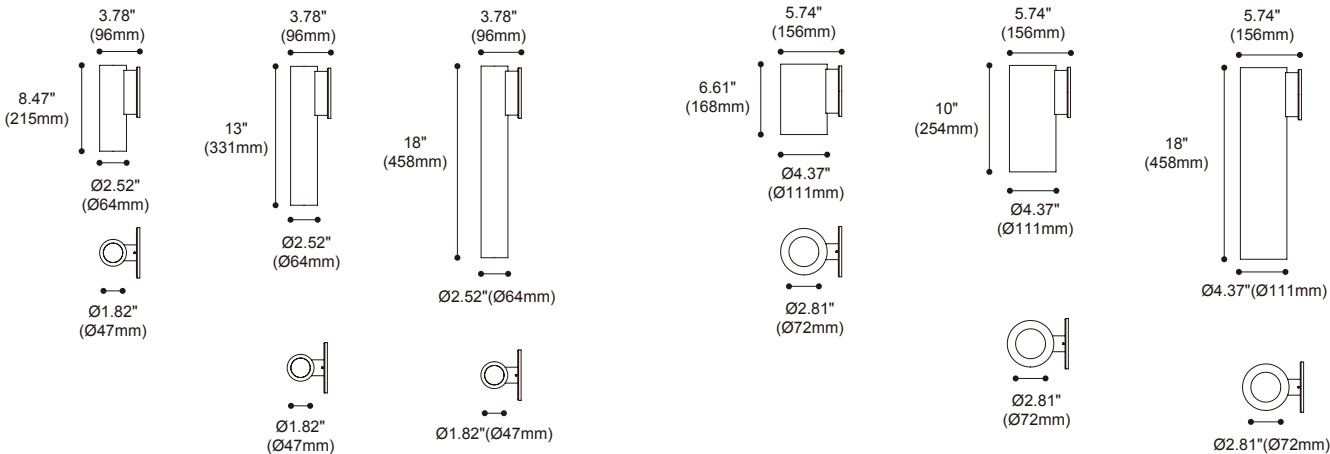

INSTALLATION GUIDE

SUSPENSION

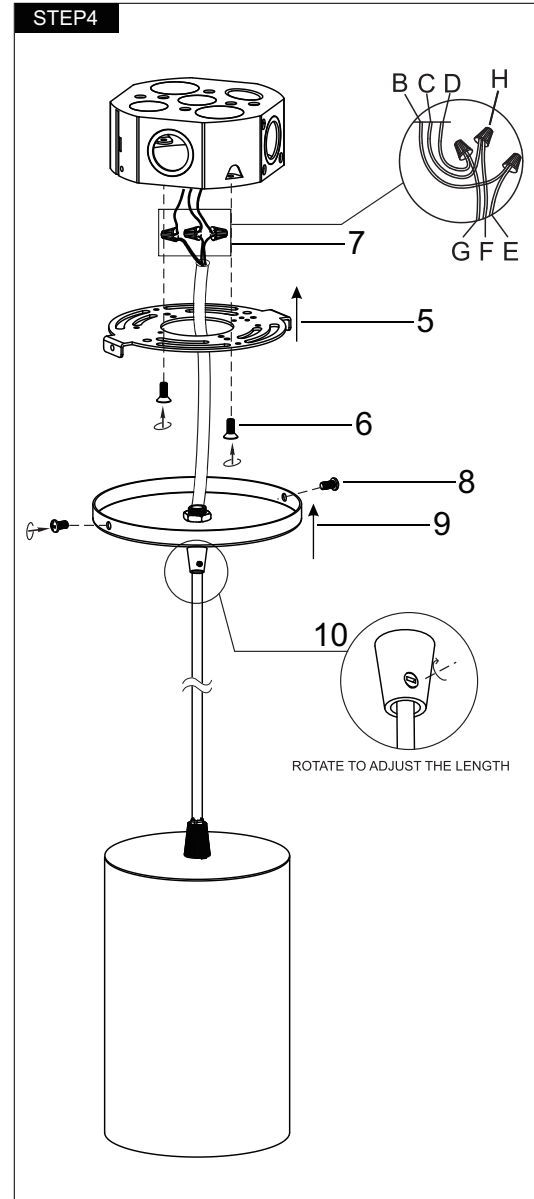
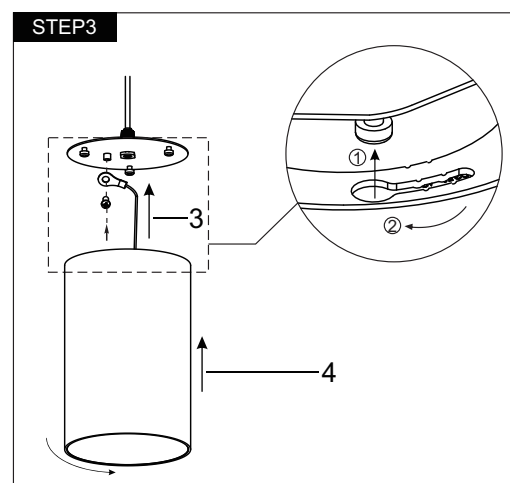
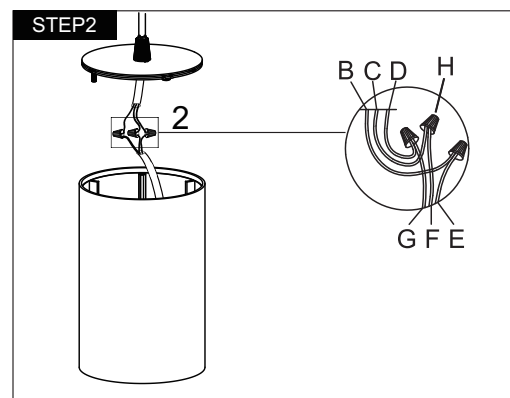
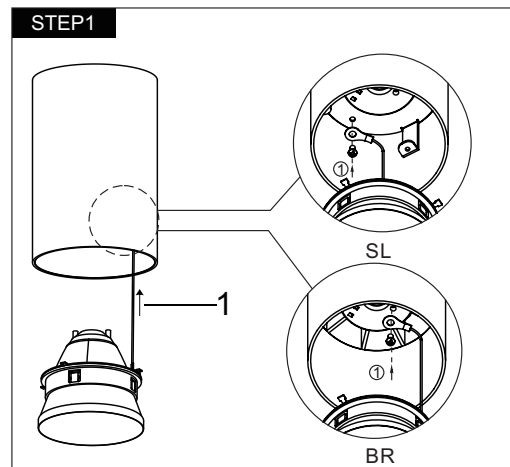

SURFACE MOUNT- SLIM

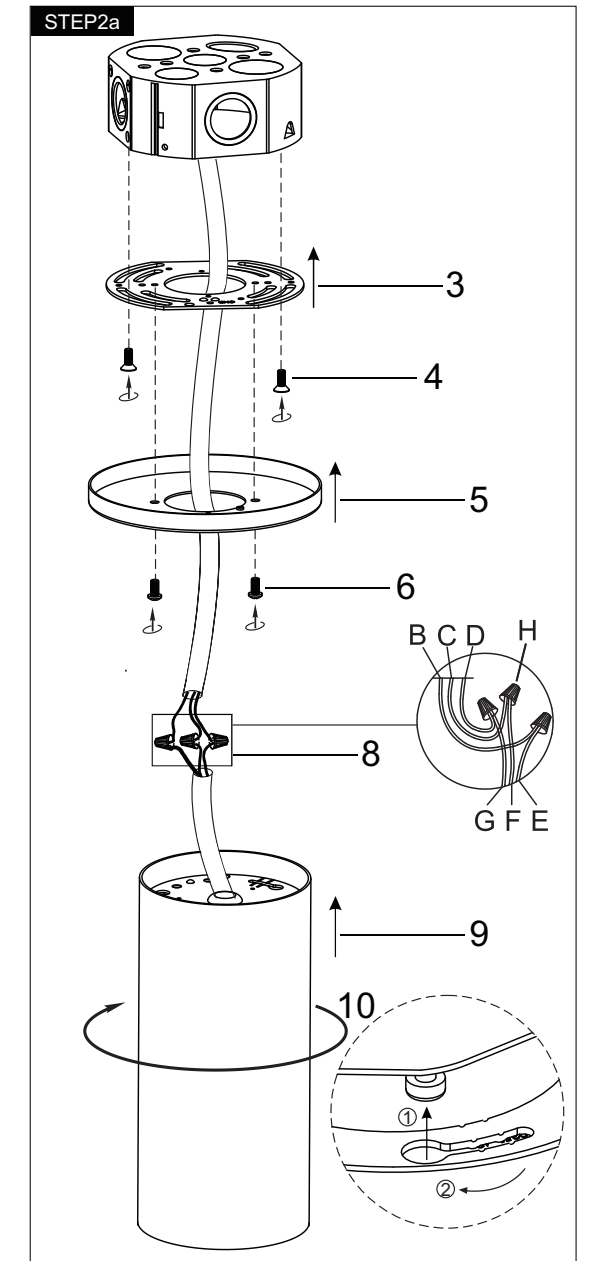
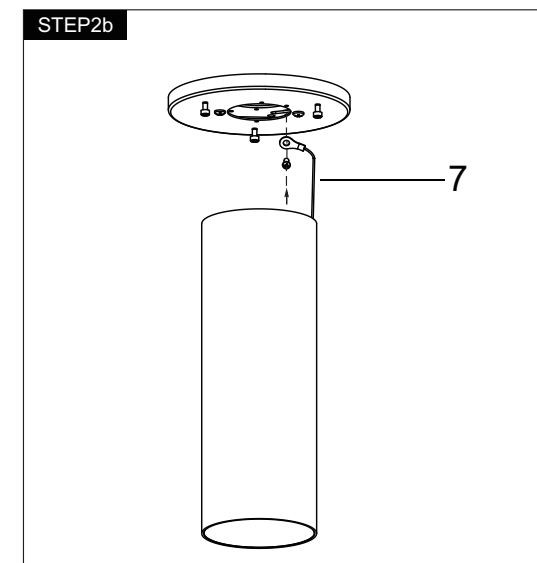
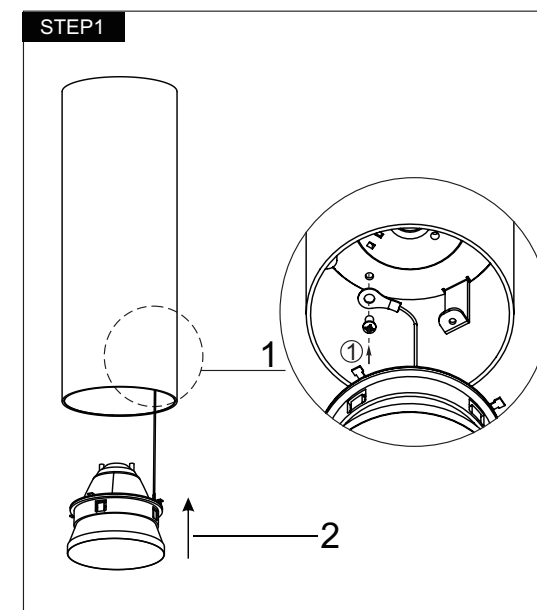

INSTALLATION GUIDE

SURFACE MOUNT- BROAD

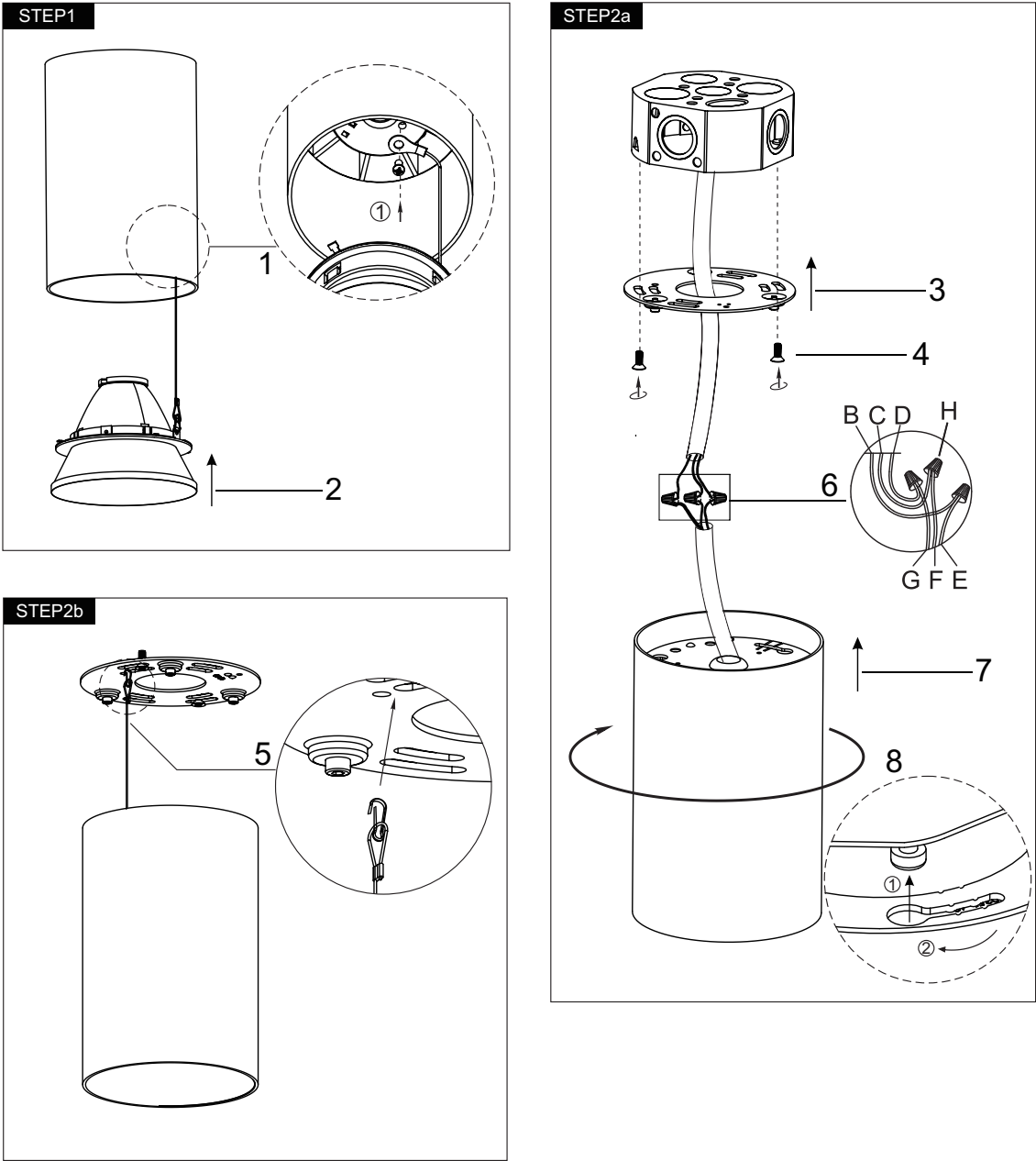

WALL MOUNT

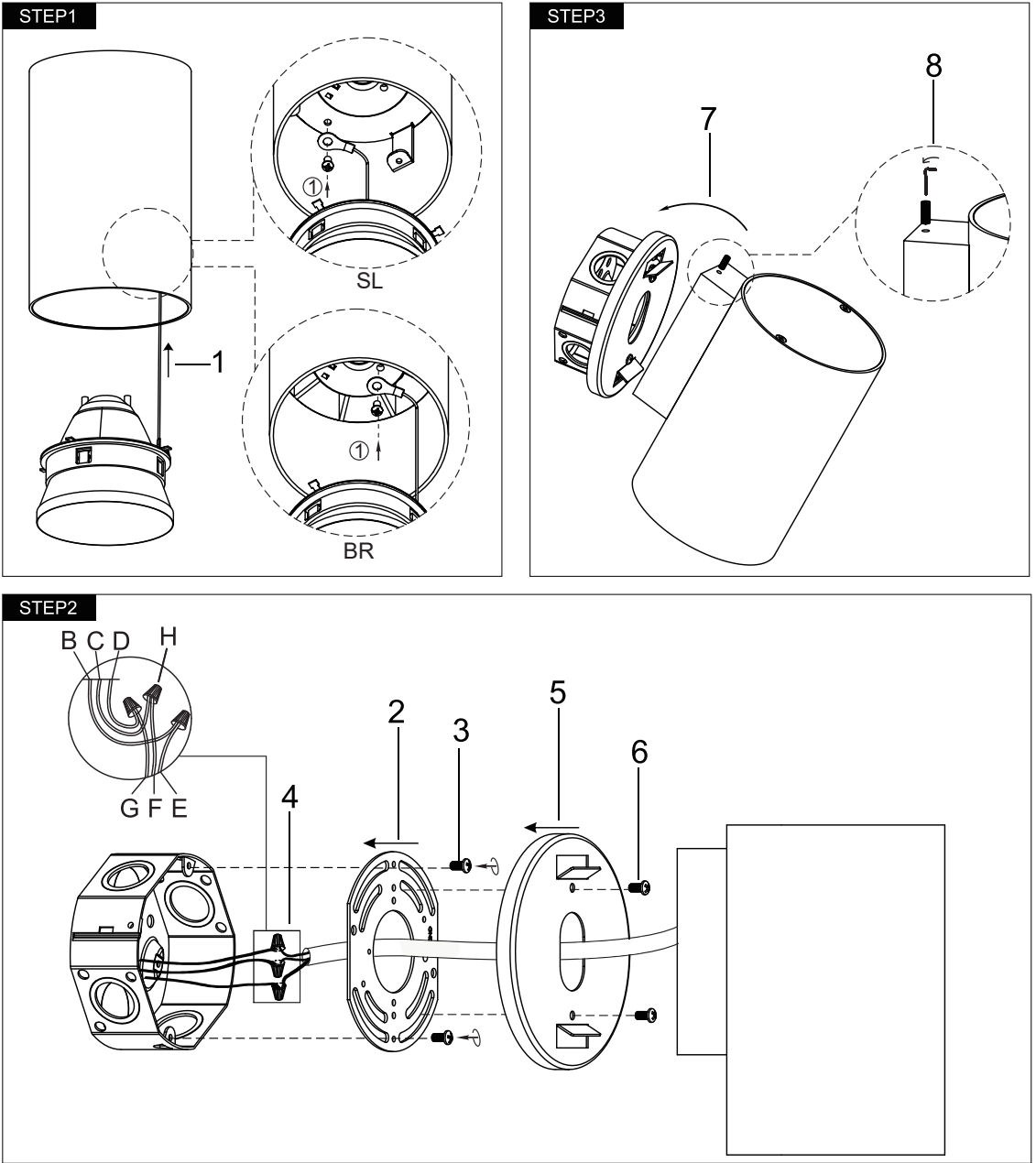

PHOTOMETRICS

Each Whiskey module sports a seamless, solid, extruded aluminum body that makes this versatile collection suitable for multiple décor styles.

SUSPENSION



13W NARROW CLEAR - SLIM

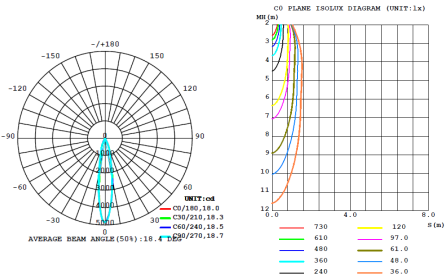

13W MEDIUM CLEAR - SLIM

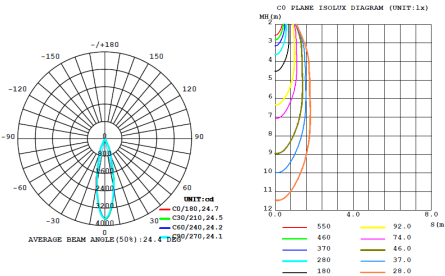

13W WIDE CLEAR - SLIM

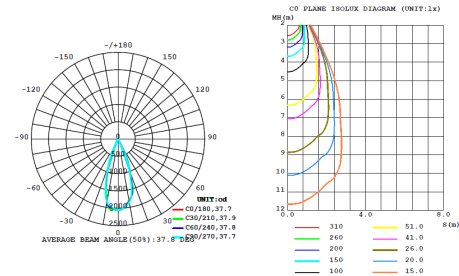

13W NARROW CLEAR - BROAD

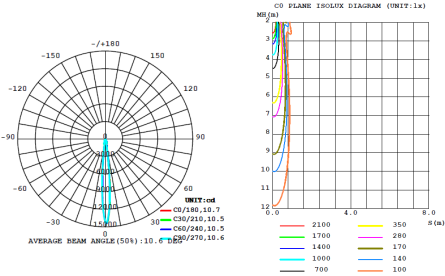

13W MEDIUM CLEAR - BROAD

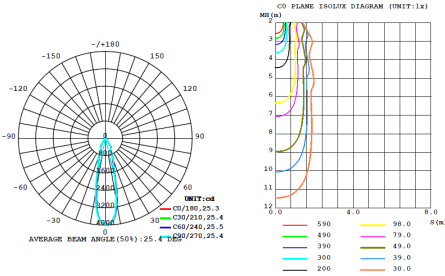

13W WIDE CLEAR - BROAD

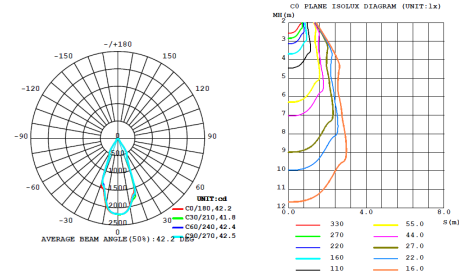

26W NARROW CLEAR - BROAD

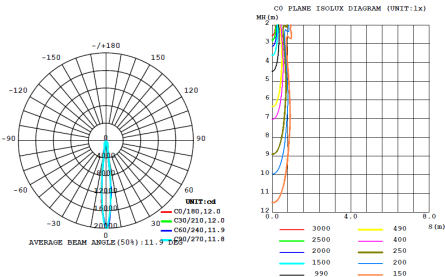

26W MEDIUM CLEAR - BROAD

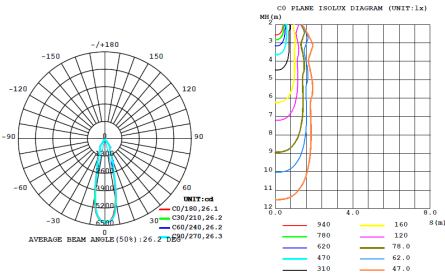

26W WIDE CLEAR - BROAD

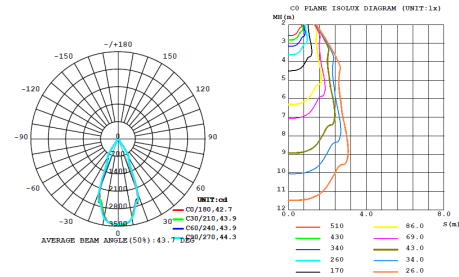

SURFACE



13W NARROW CLEAR - SLIM

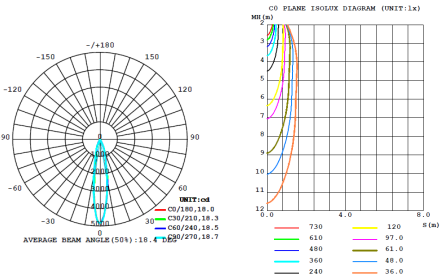

13W MEDIUM CLEAR - SLIM

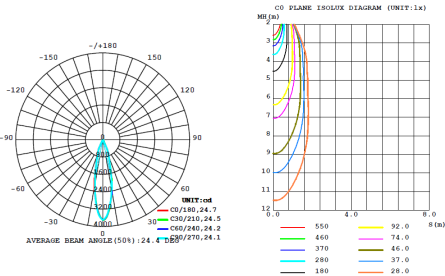

13W WIDE CLEAR - SLIM

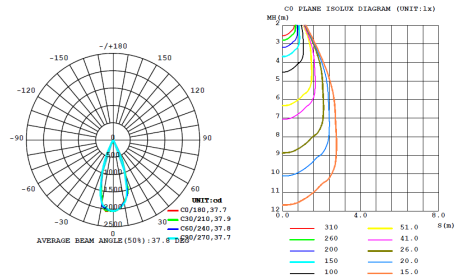

13W NARROW CLEAR - BROAD

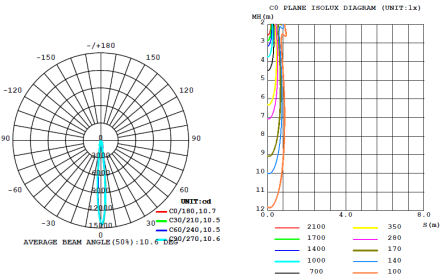

13W MEDIUM CLEAR - BROAD

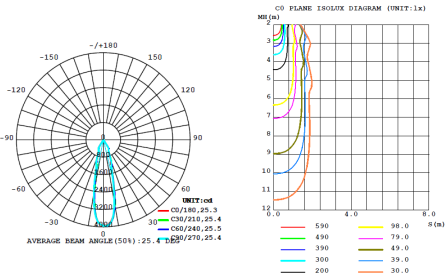

13W WIDE CLEAR - BROAD

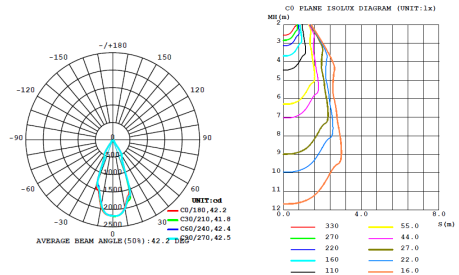

26W NARROW CLEAR - BROAD

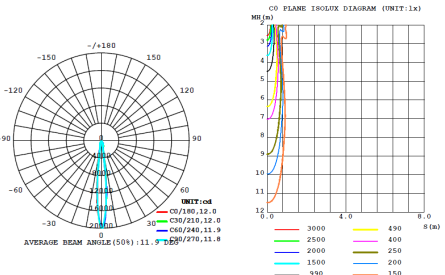

26W MEDIUM CLEAR - BROAD

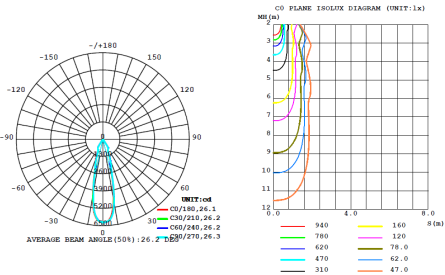

26W WIDE CLEAR - BROAD

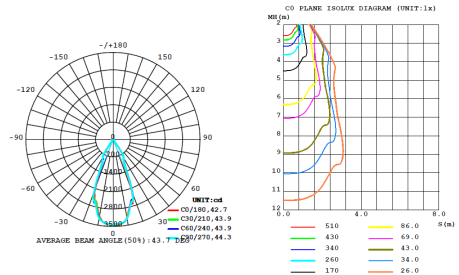

WALL



13W NARROW CLEAR - SLIM

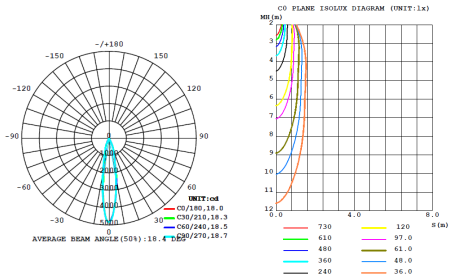

13W MEDIUM CLEAR - SLIM

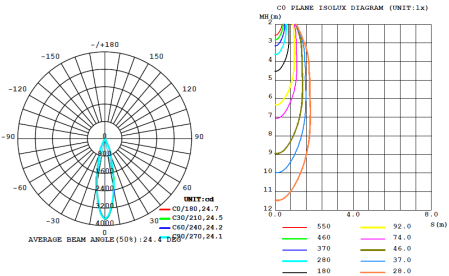

13W WIDE CLEAR - SLIM

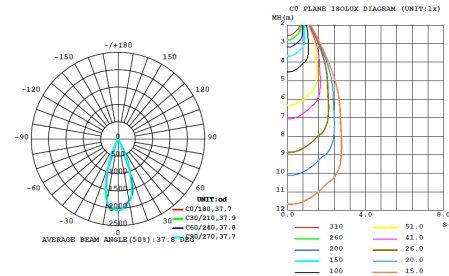

13W NARROW CLEAR - BROAD

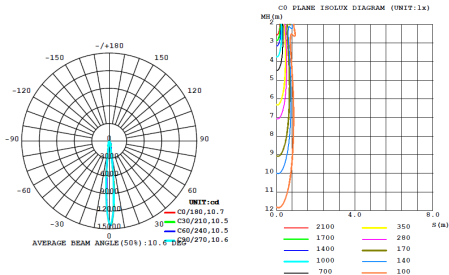

13W MEDIUM CLEAR - BROAD

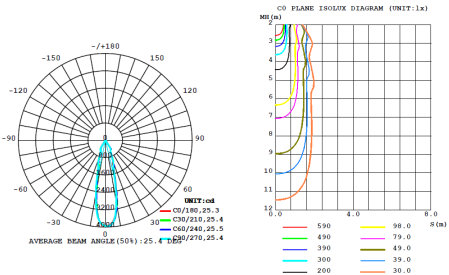

13W WIDE CLEAR - BROAD

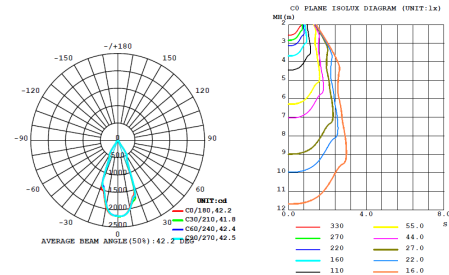

26W NARROW CLEAR - BROAD

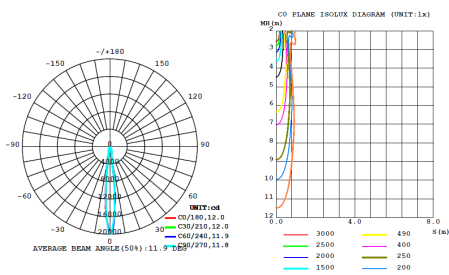

26W MEDIUM CLEAR - BROAD

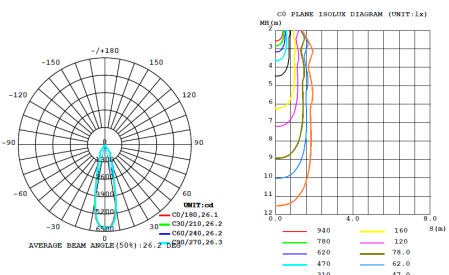

26W WIDE CLEAR - BROAD

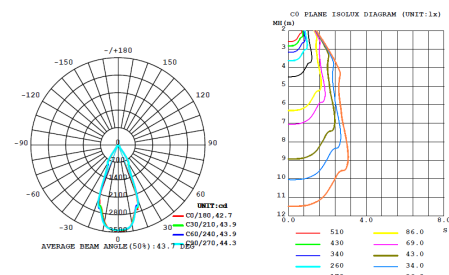



FULL CONTROL

Start at the very beginning by figuring out what type of mounting you would like. Choose from a slim or broad shape. Options include in black or white. From there, you can also decide which baffle color suits your style, whether it's black, white, chrome or gold.

ORDERING GUIDE

Start at the very beginning by figuring out what type of mounting you would like. Choose from a slim or broad shape and the size you desire. Also, you can decide which baffle color suits your style, whether it's black, white, chrome or gold. From there, you can decide to use either black or white to match your decor.

1 This first step involves choosing your mounting

Choose:
Suspension | Surface Mount | Wall Mount

Suspension



Surface Mount



Wall Mount



2 Decide the size.

SLIM 8"



SLIM 13"



SLIM 18"



BROAD 6"



BROAD 10"



BROAD 18"



3 Connect!

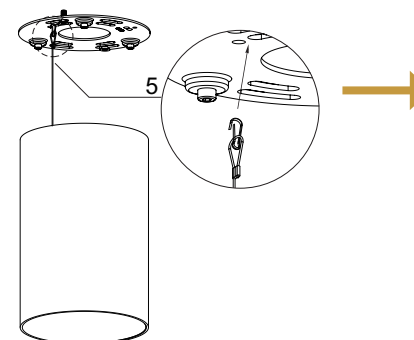

CONFIGURATOR

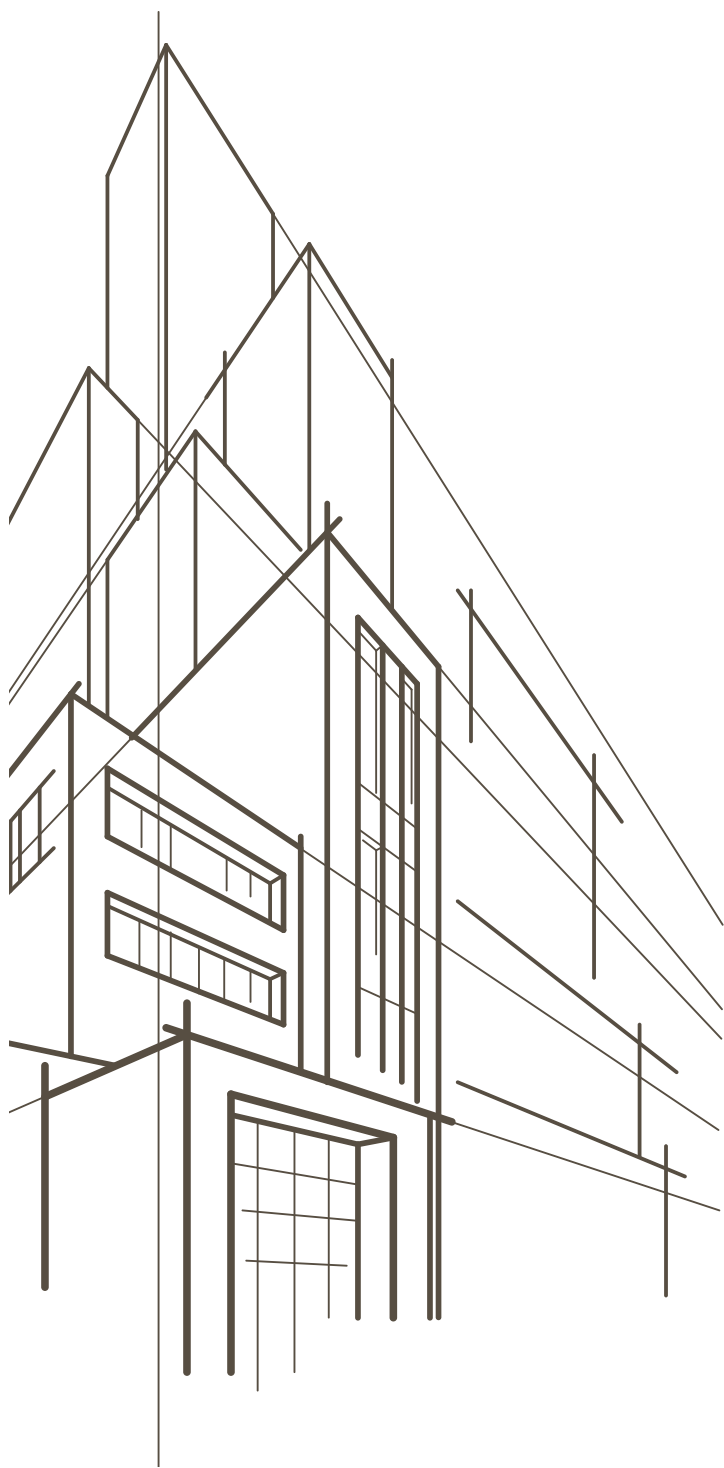

BEGIN BUILDING YOUR CONFIGURATION

PART A

Begin by choosing the mounting style and size to build your configuration. Design the aesthetics including the, light color and baffle color.

COLLECTION (FAMILYNAME)	MOUNTING		COLOR		DIMENSIONS		BAFFLE COLOR	
WHS	SU	SUSPENSION	01	BLACK	SL8	2.5" X DIA X 8" HEIGHT	01	BLACK
	S	SURFACE MOUNT	02	WHITE	SL13	2.5" X DIA X 13" HEIGHT	02	WHITE
	W	WALL MOUNT			SL18	2.5" X DIA X 18" HEIGHT	03	CHROME
					BR6	4.5" X DIA X 6" HEIGHT	04	GOLD
					BR10	4.5" X DIA X 10" HEIGHT		
					BR18	4.5" X DIA X 18" HEIGHT		

COMPLETE YOUR ORDER BY CHOOSING YOUR SPECIFICS

PART B

Finish your order by choosing the wattage, color temperature, beam angle, and the diffuser accessory.

WATT		CCT		BEAM ANGLE		DIFFUSER	
13	13W	27	2700K	N	15° NARROW	CL	CLEAR DIFFUSER
26	26W (BR ONLY)	30	3000K	M	24° MEDIUM	LN	LINEAR SPREAD DIFFUSER
		35	3500K	W	38° WIDE	FR	FROSTED DIFFUSER
		40	4000K			SP	SPREAD DIFFUSER
						HC	HONEYCOMB LOUVRE
						RE	RED DICHROIC
						GR	GREEN DICHROIC
						BL	BLUE DICHROIC
						OR	ORANGE DICHROIC

Fase¹

33 West Beaver Creek Road,
Richmond Hill, Ontario Canada L4B 1L8

DALLAS TRADE MART
Eurofase Showroom, Suite #4002

tel 905.695.2055
fax 905.695.2056

toll free 1.800.660.5391
toll free 1.800.660.5390



Printed in Canada
© 2021 Eurofase Inc. All rights reserved.

Eurofase Inc. reserves the right to make alterations to the construction and design of products shown in this catalog in order to meet the laws or regulations of any authorized governing organization. The use of products shown in this catalog must comply with local building codes.