

WHISKY

Fase¹_{TM}



BRAVO
OSCAR
TANGO
WHISKEY





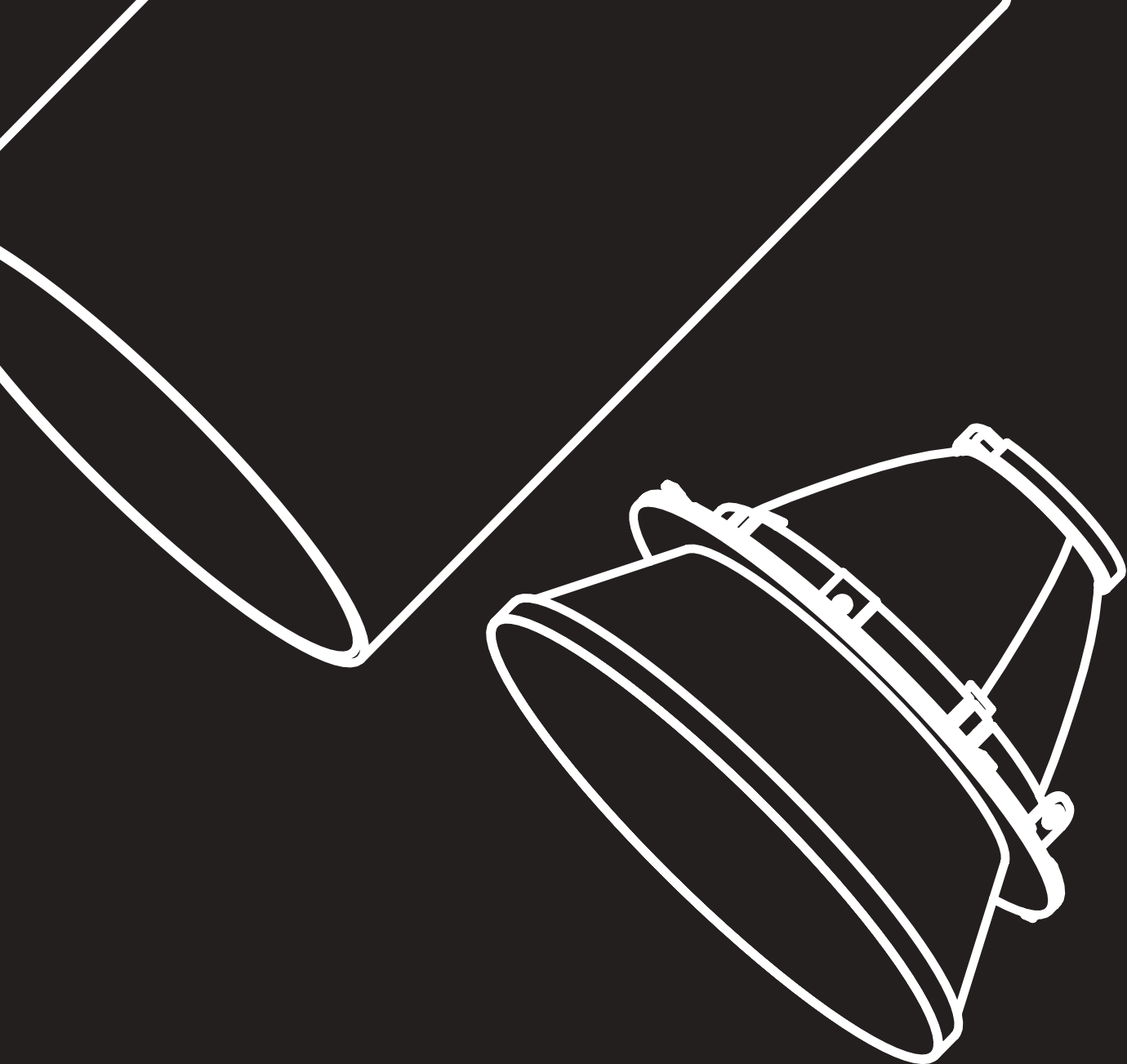

WHIS
KEY

Introducing

THE WHISKEY

Whiskey is a modular lighting system, ornate yet simplistic in nature. The tubular-minimalistic design is seamless and will illuminate any commercial setup. It offers 2.5" and 4.5" diameter apertures with wattages up to 26W.

The architectural cylinders are made with solid extruded aluminium and are available in a suspension, surface and wall mount application, making it a versatile addition to multiple settings. The collection has a sleek and clean finish with a minimalistic approach, making this collection trendy and extremely adaptable for your space.

Its time to get Whiskey'd away.



MOUNT STYLES

Whiskey offers three mounting options for ease of installation with chic style. The first is a suspension option followed by the widely anticipated surface mount which provides exemplary style. This modern take will elevate your space without having to impose invasive installation practices.

The third is a wall mount application that provides just the right amount of illumination as ambience lighting for spaces like vanity areas or corridors. Choose between these flexible mounting styles to create a cohesive interior design.



...ch bread the
...heat Fry the
...and cover with
...combine t
...a medium bowl.
...cover them with
...SALT
...15 minutes
...oregano, W

Best Cooking Methods for
Certified Steak &
Seared Steaks
Certified Steaks are
Seared in butter,
tender, juicy and full
of flavor.
Recommend cooking method
Mix strong bread flour salt and
oil strong bread flour grilling

Brown in oven 15 minutes
a sugar, vinegar, oregano, W



LIGHT CHOICE

Each Whiskey module sports a seamless, solid, extruded aluminum body that makes this versatile collection suitable for multiple décor styles. Built to last, choose between three different heights and mounting options to meet your every need.



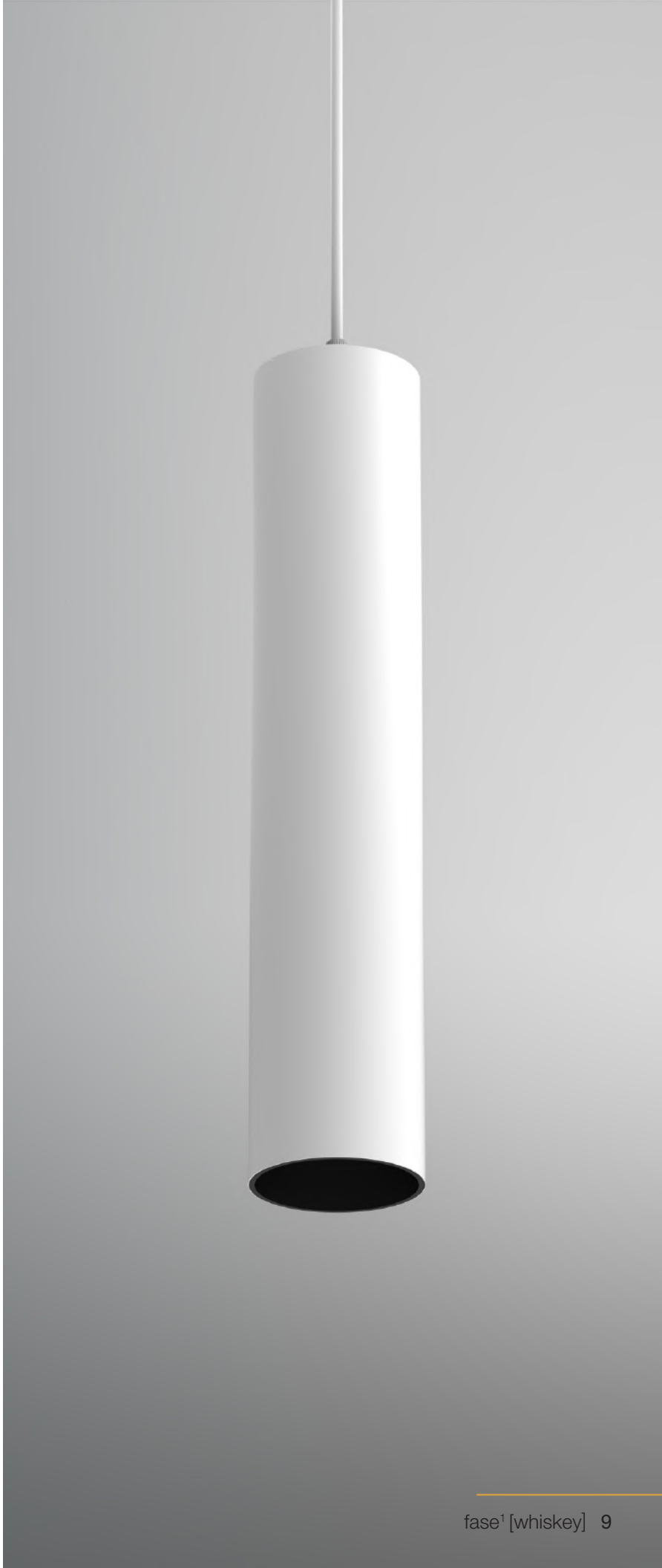

SUSPENSION

The suspension module, as the more decorative piece of this collection, works just like a hanging pendant but incorporates a sleeker and more compact style. With its seamless design and minimalistic approach, you can creatively light up any space.



All housing available in white and black

LAMPING

Wattage:	13W	26W
Source:	Integrated LED	Integrated LED
Beam angle:	15°/24°/38°	15°/24°/38°
Kelvin:	2700K/3000K/3500K/4000K	2700K/3000K/3500K/4000K
Lumens:	1260lm	2030lm
CRI:	90+	90+
Dimming:	0-10V/ELV/Triac	0-10V/ELV/Triac
Location:	Damp	Damp
Input:	120-277V (347 upon request)	120-277V (347 upon request)
Color:	Black/White	Black/White
Type:	Slim/Broad	Broad

SPECIFICATION DRAWINGS

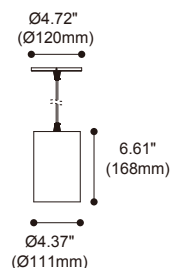

13W WIDE

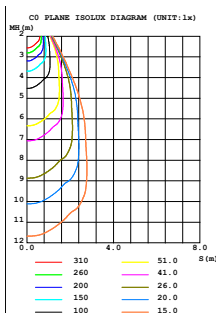
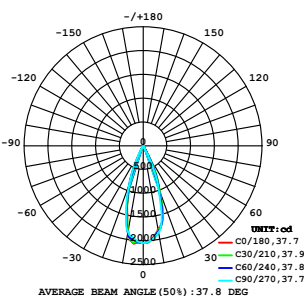

26W WIDE

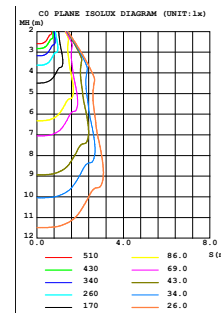
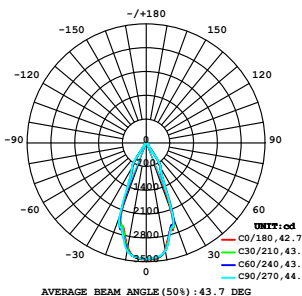

** See pg 28 for full photometrics

*** For customization, please consult Eurofase



SURFACE

For this module, the light fixture is mounted to the ready-to-install plate that is attached to the ceiling. It works perfectly in spaces with drop down, exposed, and structural ceilings. It includes a reflector that allows three kinds of light flow: spot, flood, and wide flood which allows you to illuminate your space as required. Also offered in a broad and a slim version.



All housing available in white and black

LAMPING

Wattage:	13W	26W
Source:	Integrated LED	Integrated LED
Beam angle:	15°/24°/38°	15°/24°/38°
Kelvin:	2700K/3000K/3500K/4000K	2700K/3000K/3500K/4000K
Lumens:	1260lm	2030lm
CRI:	90+	90+
Dimming:	0-10V/ELV/Triac	0-10V/ELV/Triac
Location:	Damp	Damp
Input:	120-277V (347 upon request)	120-277V (347 upon request)
Color:	Black/White	Black/White
Type:	Slim/Broad	Broad

SPECIFICATION DRAWINGS

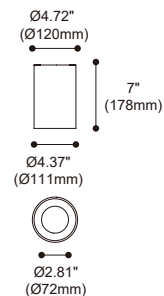
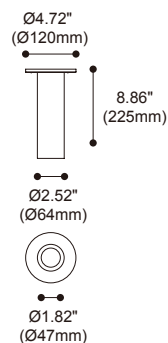

13W WIDE

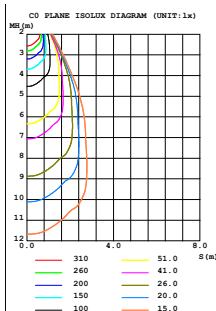
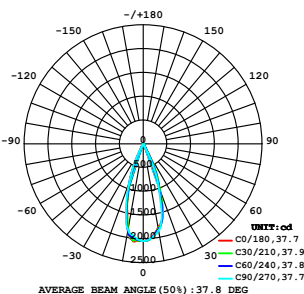

26W WIDE

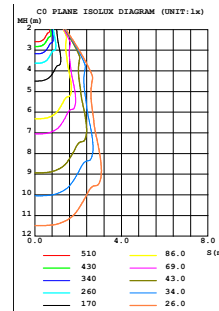
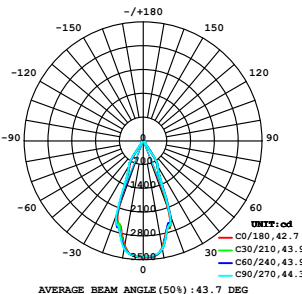

** See pg 28 for full photometrics

*** For customization, please consult Eurofase



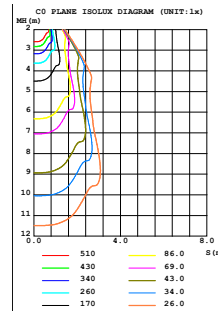

*** For customization, please consult Eurofase



01

ACCESSORIES

OPTIC REFLECTORS: Beam Angle

Spot	Narrow 15°
Flood	Medium 24°
Wide Flood	Wide 38°



Reflectors installed into the light engine, before the diffusers

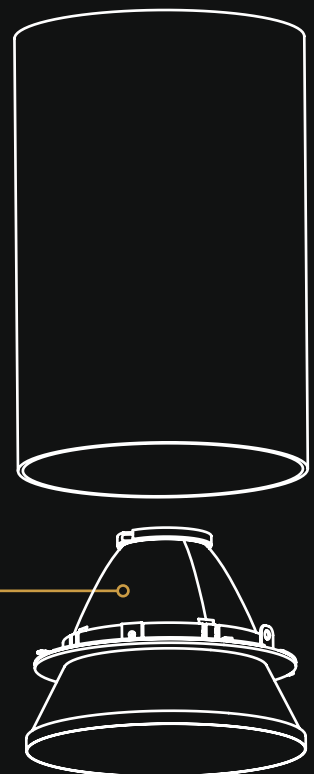

02

BAFFLE: Finishes

Black
White
Chrome
Gold

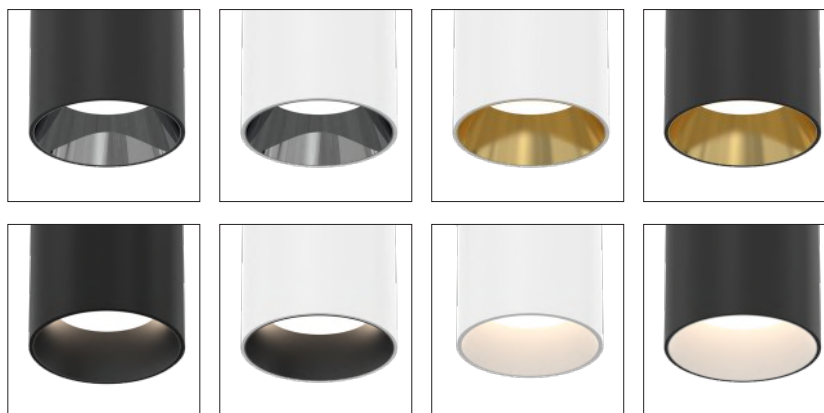

03

LENS: Diffuser

Standard Lens (INCLUDED)

Clear glass protective lens

Dichroic Lens

Accurately filter colors to change room ambiance (Orange/Red/Blue/Green)

Spread Lens

Wider beam diffuser to focus on larger objects

Linear Spread Lens

Oval flood beam best suited for wall washing applications

Frosted Lens

Disperses light evenly with a soft, diffused glow

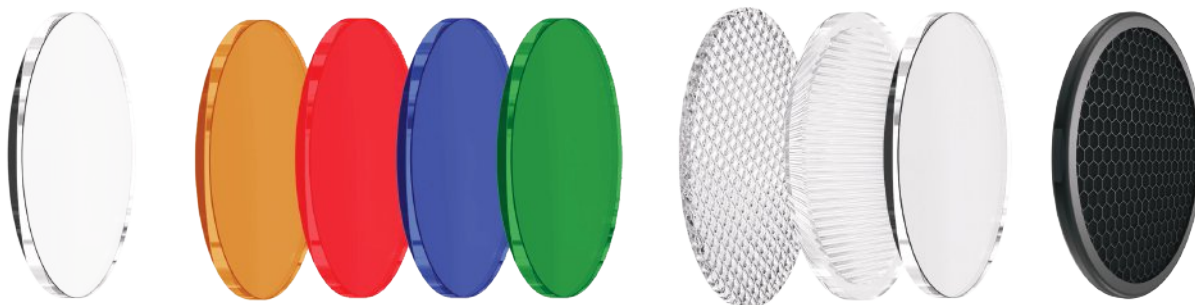



LASTING IMPRESSION

The Whiskey collection are UL Listed to ensure safe operation for many years to come. We want to ensure your success with every project you tackle. We're also offering a 5 year limited warranty.



DIMENSION DRAWINGS

SUSPENSION

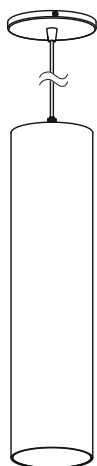

SURFACE

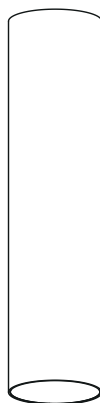

WALL

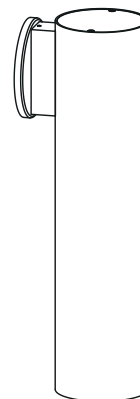

SUSPENSION

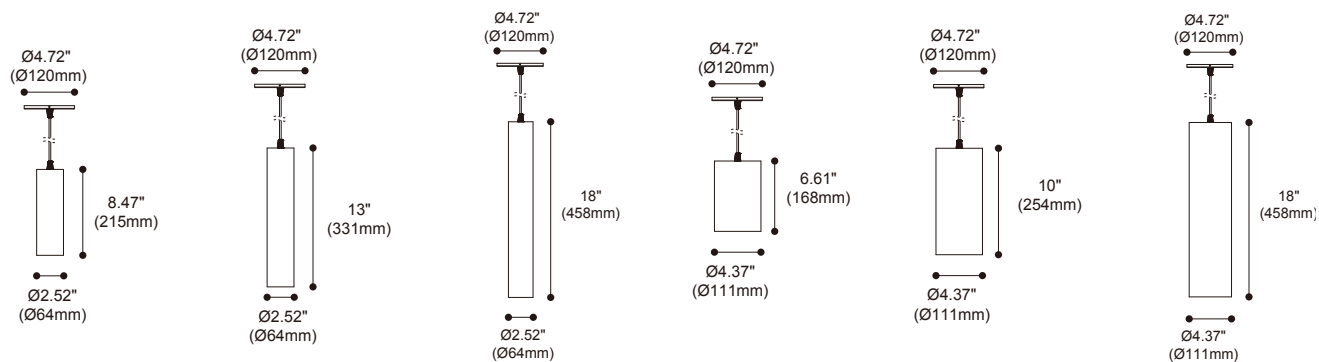

SURFACE MOUNT

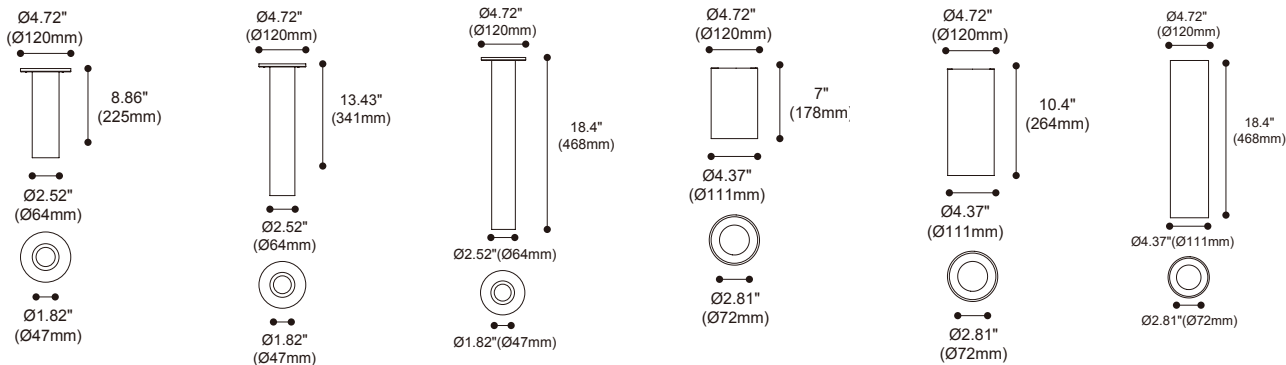

WALL MOUNT

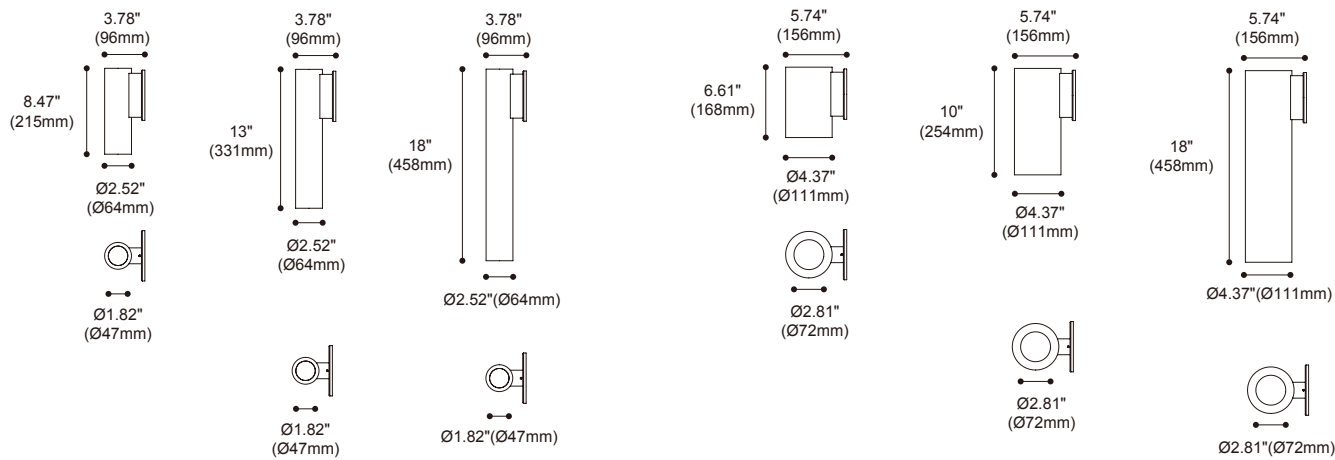

INSTALLATION GUIDE

SUSPENSION

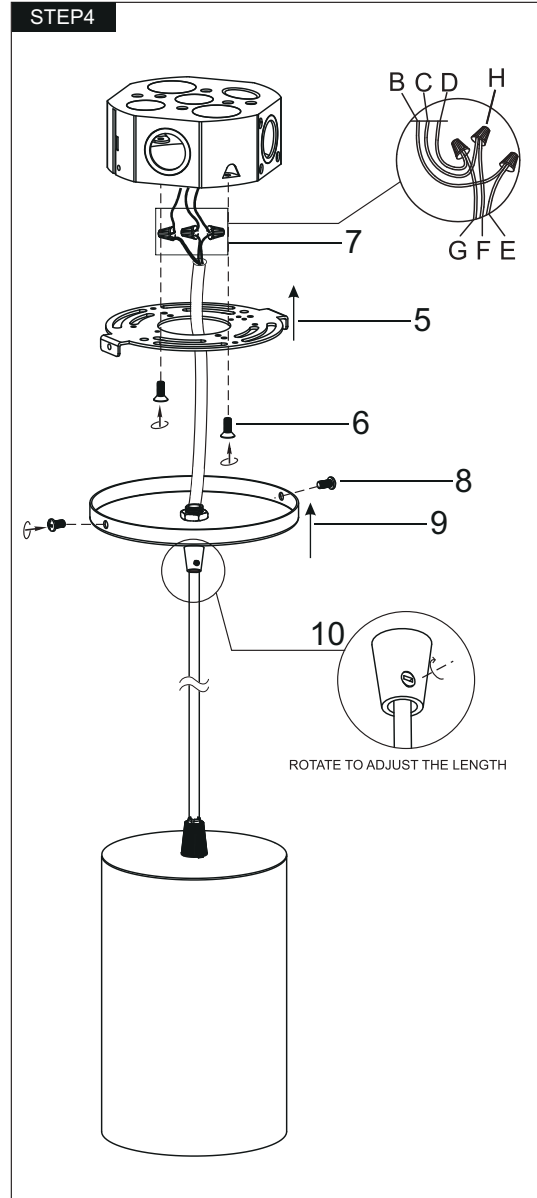
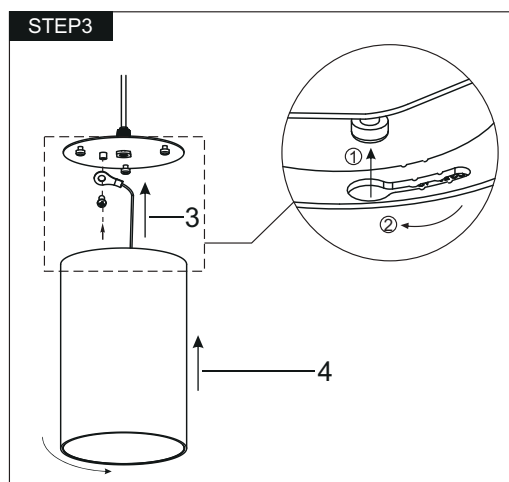
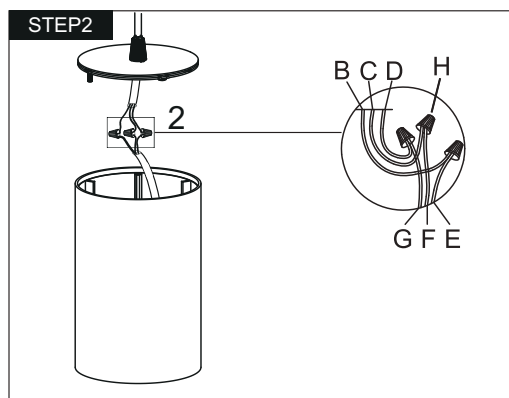
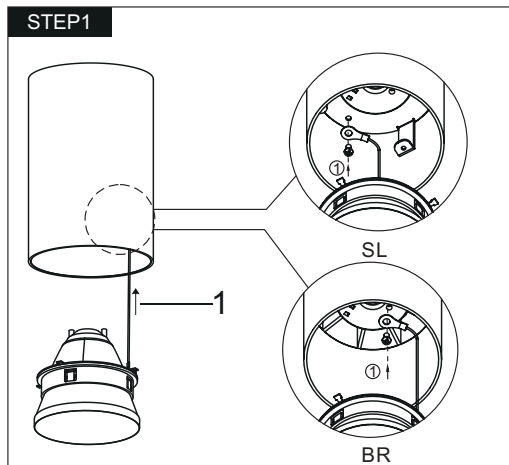

SURFACE MOUNT-SLIM

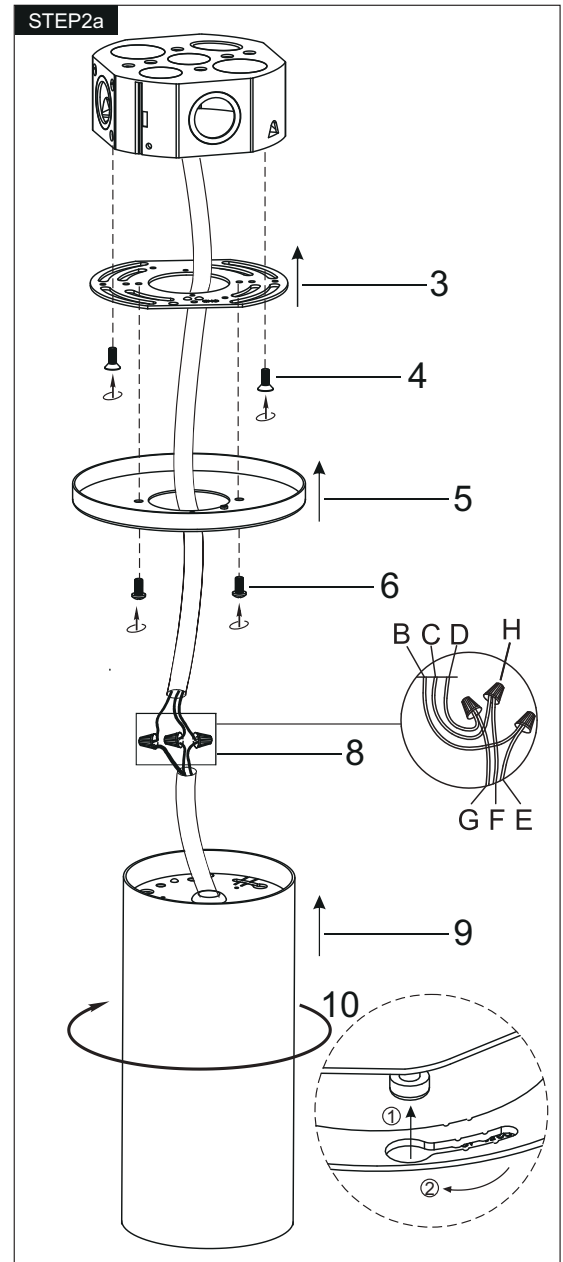
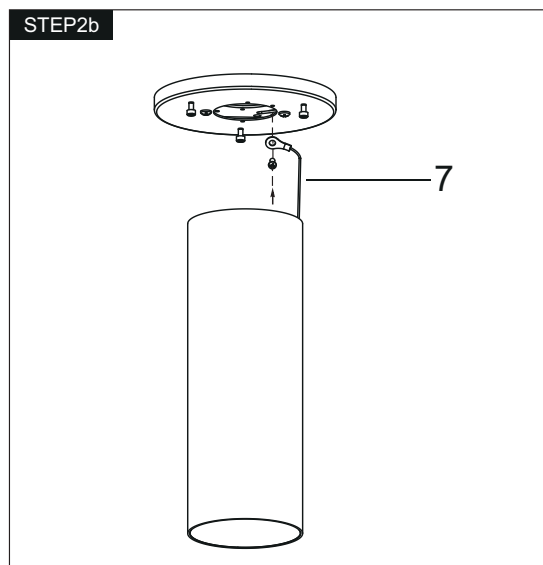
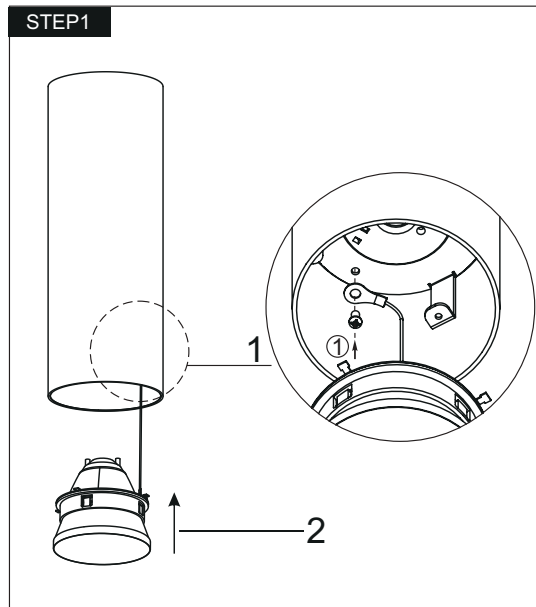

INSTALLATION GUIDE

SURFACE MOUNT- BROAD

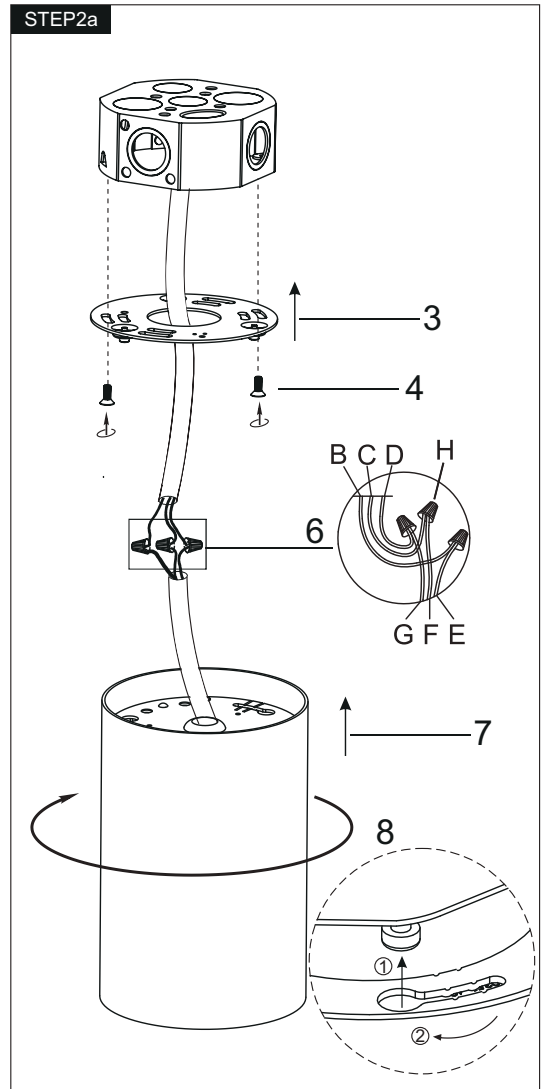
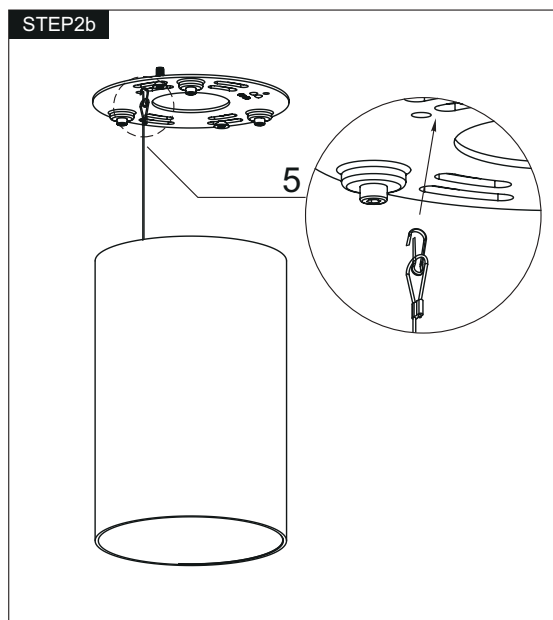
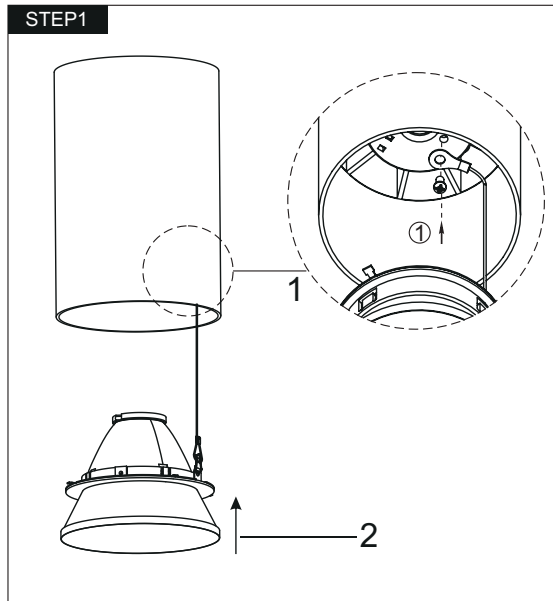

WALL MOUNT

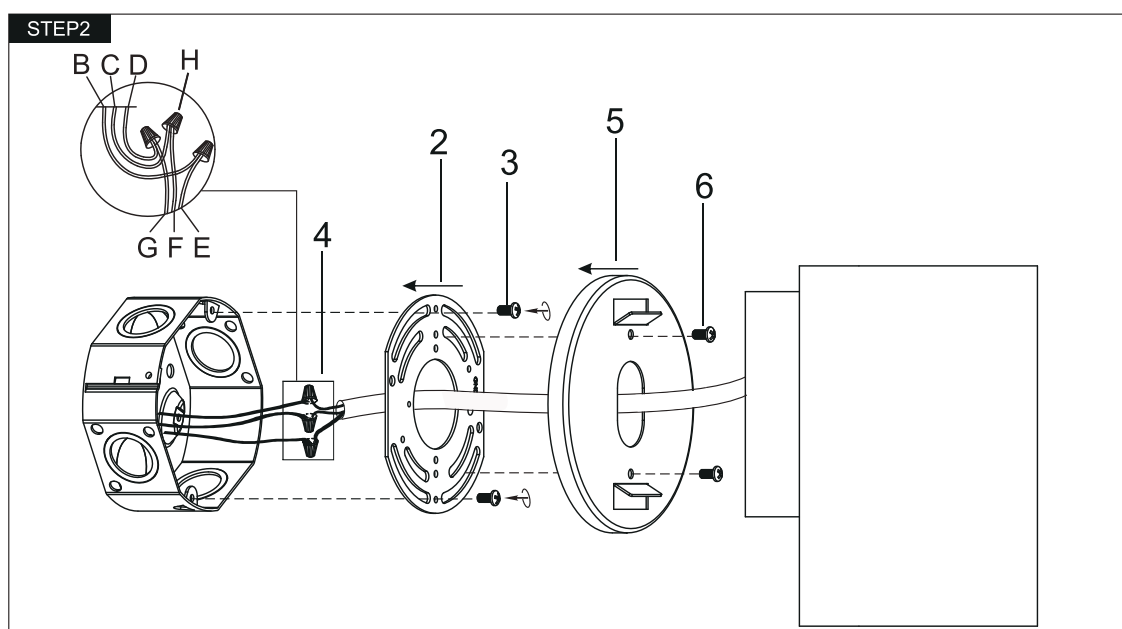
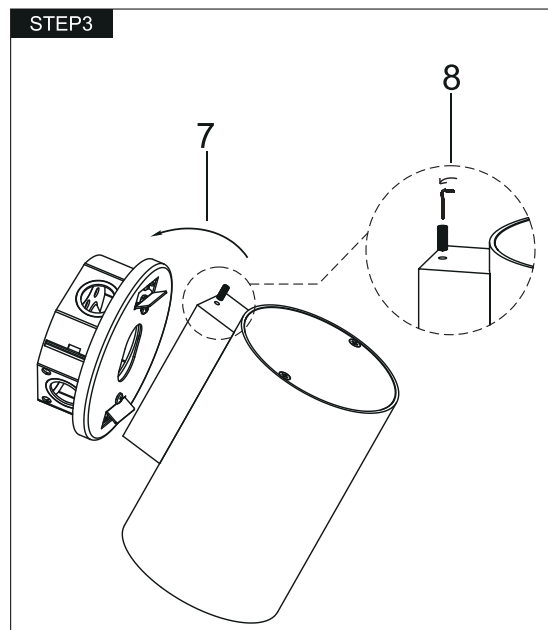
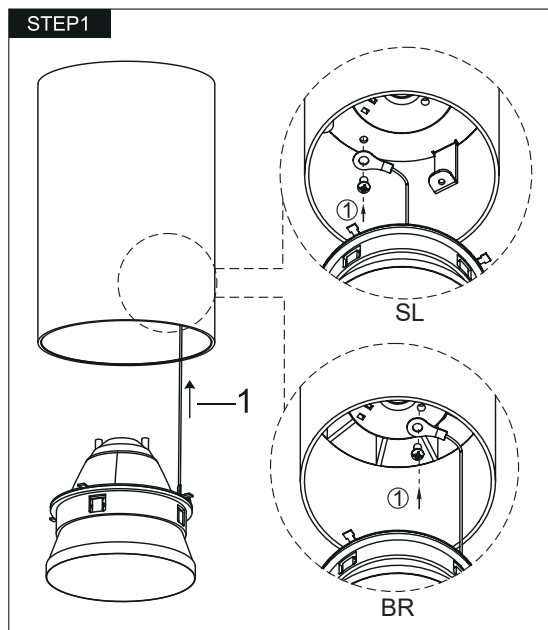

Each Whiskey module sports a seamless, solid, extruded aluminum body that makes this versatile collection suitable for multiple décor styles.

Figure 10 consists of two plots. The left plot is a polar coordinate system showing the average beam angle (deg) versus the average beam angle (deg). The right plot is a line graph showing the beam width (mm) versus the average beam angle (deg).

The left plot is a polar coordinate system with the following data series:

- UNIT: mm
- 730/150, 18.0
- 610/215, 18.3
- 510/260, 18.5
- 420/270, 18.7

The right plot is a line graph showing the beam width (mm) versus the average beam angle (deg). The data series are:

- 730 (red line)
- 610 (blue line)
- 510 (green line)
- 420 (cyan line)
- 320 (magenta line)
- 220 (yellow line)

Figure 10 consists of two plots. The left plot is a polar plot showing the average beam angle (deg) as a function of azimuthal angle (deg). The radial axis represents the beam angle, ranging from 0 to 180 degrees. The angular axis represents the azimuthal angle, ranging from 0 to 360 degrees. The plot shows a color-coded distribution of beam angles, with a legend indicating values from 0 to 180 degrees. The right plot is a 3D plot showing the average beam angle (deg) as a function of azimuthal angle (deg). The vertical axis represents the beam angle, ranging from 0 to 180 degrees. The horizontal axis represents the azimuthal angle, ranging from 0 to 360 degrees. The plot shows a color-coded distribution of beam angles, with a legend indicating values from 0 to 180 degrees.

Figure 10 consists of two plots. The left plot is a polar plot showing the average beam angle (DB) as a function of angle (degrees). The right plot is an O-Plane S-Plane Diagram showing the magnitude (dB) as a function of frequency (MHz).

Polar Plot Data (Approximate):

Angle (Degrees)	Average Beam Angle (DB)
0	37.0
90	37.0
180	37.0
270	37.0
360	37.0

O-Plane S-Plane Diagram Data (Approximate):

Frequency (MHz)	310° (dB)	250° (dB)	200° (dB)	150° (dB)	100° (dB)	50° (dB)	0° (dB)	-50° (dB)	-100° (dB)	-150° (dB)	-200° (dB)	-250° (dB)	-310° (dB)
0.0	31.0	25.0	20.0	15.0	10.0	5.0	0.0	-5.0	-10.0	-15.0	-20.0	-25.0	-31.0
4.0	53.0	43.0	36.0	28.0	20.0	12.0	4.0	-4.0	-12.0	-20.0	-28.0	-36.0	-53.0
8.0	53.0	43.0	36.0	28.0	20.0	12.0	4.0	-4.0	-12.0	-20.0	-28.0	-36.0	-53.0

Figure 10 consists of two plots. The left plot is a polar plot of the radiation pattern in the horizontal plane, showing the main beam at 0 degrees and side lobes at approximately 120 and 240 degrees. The right plot is a 2D line graph of the radiation pattern in the vertical plane, showing the main beam at 0 degrees and side lobes at approximately 120 and 240 degrees. Both plots include a legend for the radiation pattern components: CSH/016, CSH/240, CSH/120, and CSH/180.

Figure 10 consists of two plots. The left plot is a polar plot titled "CP PLANE ISOLATION DIAGRAM (UNIT: 1m)". The horizontal axis represents the beam angle in degrees, ranging from -180 to 180. The vertical axis represents the distance in meters, ranging from 0 to 12. The plot shows a series of concentric circles and radial lines, indicating the beam's path. The right plot is a line graph titled "CP PLANE ISOLATION DIAGRAM (UNIT: 1m)". The horizontal axis represents the beam angle in degrees, ranging from -180 to 180. The vertical axis represents the distance in meters, ranging from 0 to 12. The plot shows several curves representing the beam's path for different frequencies: 3000, 2500, 2000, 1500, 1000, 500, 250, and 100 MHz. The curves are color-coded and labeled with their respective frequencies.

Figure 10 consists of two plots. The left plot is a polar plot titled "AVERAGE BEAM ANGLE (deg): 26.2" showing beam intensity (dB) on a logarithmic scale from -30 to 150. The right plot is a linear plot titled "CP BEAM PROFILE DIAGRAM (UNIT: 1s)" showing beam intensity (dB) on a logarithmic scale from 0 to 15. Both plots show multiple colored lines representing different beam profiles, with a legend on the right side of the linear plot.

The figure consists of two plots. The left plot is a polar plot of the radiation pattern in the horizontal plane. The radial axis represents the signal strength in dBm, ranging from -120 to -30. The angular axis represents the azimuth angle in degrees, ranging from 0 to 360. The plot shows a main lobe pointing towards 180 degrees, with a peak signal strength of approximately -30 dBm. The side lobes are significantly lower, around -100 dBm. The right plot is a line graph of the radiation pattern in the vertical plane. The vertical axis represents the elevation angle in degrees, ranging from 0 to 120. The horizontal axis represents the signal strength in dBm, ranging from -120 to -30. The plot shows a main lobe peaking at approximately -30 dBm at an elevation angle of 0 degrees. The side lobes are significantly lower, around -100 dBm. The legend for both plots is as follows:

Line Color	Frequency (MHz)	Power (dBm)
Red	510	86.0
Green	430	69.0
Blue	340	43.0
Purple	260	24.0
Black	130	9.0

SURFACE



13W NARROW CLEAR - SLIM

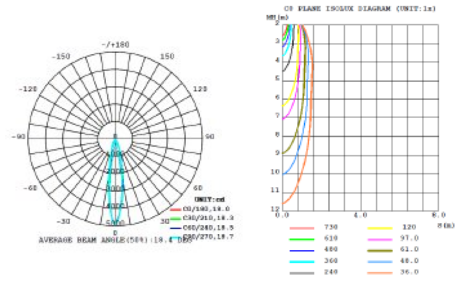

13W MEDIUM CLEAR - SLIM

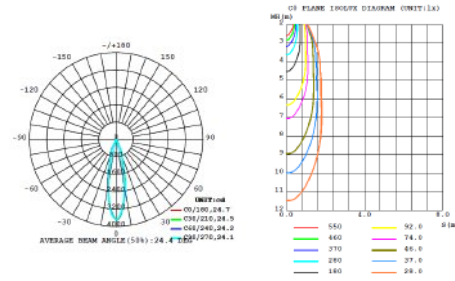

13W WIDE CLEAR - SLIM

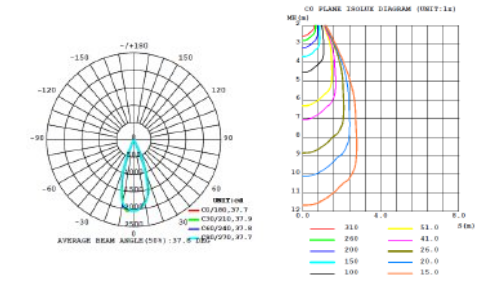

13W NARROW CLEAR - BROAD

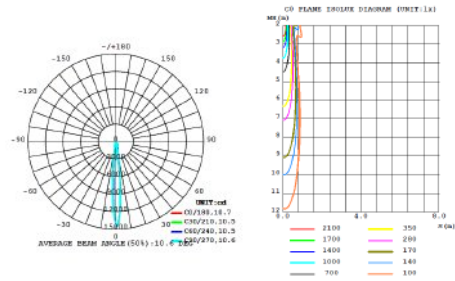

13W MEDIUM CLEAR - BROAD

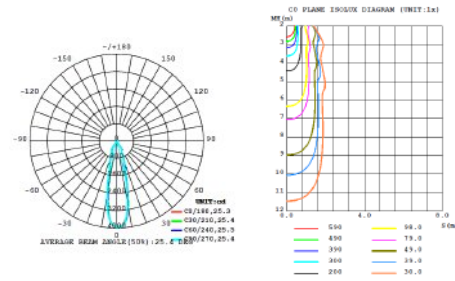

13W WIDE CLEAR - BROAD

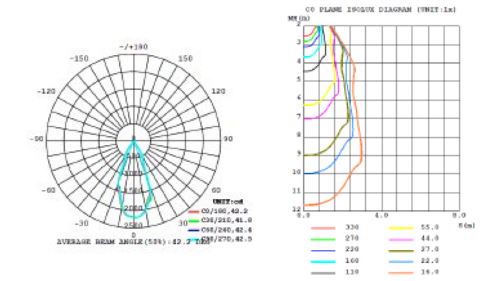

26W NARROW CLEAR - BROAD

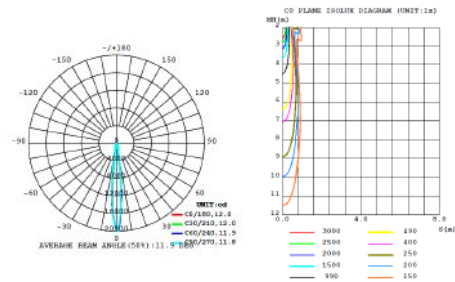

26W MEDIUM CLEAR - BROAD

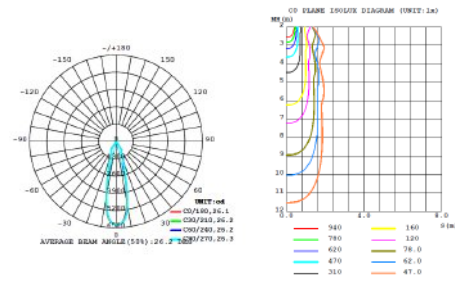

26W WIDE CLEAR - BROAD

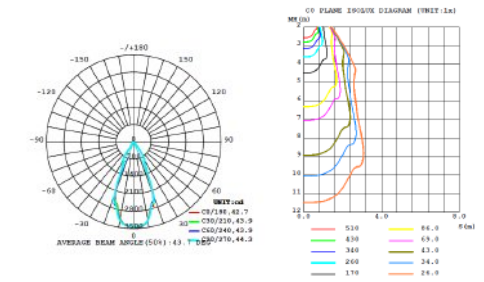



CF FAN INSIDE DIAGRAM (UNIT: 1m)

A polar plot showing beam angles and distances for various fan models. The radial axis represents distance in meters (m), ranging from 0.0 to 8.0. The angular axis represents beam angle in degrees, ranging from -150 to 150. The plot shows several curves representing different fan models, with their respective beam angles and distances listed in the legend.

Legend:

- CF120/18.0 (Red)
- CF120/21.0 (Blue)
- CF120/24.0 (Green)
- CF120/27.0 (Yellow)
- CF120/30.0 (Purple)
- CF120/33.0 (Pink)
- CF120/36.0 (Light Blue)
- CF120/39.0 (Light Green)
- CF120/42.0 (Light Yellow)
- CF120/45.0 (Light Purple)
- CF120/48.0 (Light Pink)
- CF120/51.0 (Light Blue)
- CF120/54.0 (Light Green)
- CF120/57.0 (Light Yellow)
- CF120/60.0 (Light Purple)
- CF120/63.0 (Light Pink)
- CF120/66.0 (Light Blue)
- CF120/69.0 (Light Green)
- CF120/72.0 (Light Yellow)
- CF120/75.0 (Light Purple)
- CF120/78.0 (Light Pink)
- CF120/81.0 (Light Blue)
- CF120/84.0 (Light Green)
- CF120/87.0 (Light Yellow)
- CF120/90.0 (Light Purple)
- CF120/93.0 (Light Pink)
- CF120/96.0 (Light Blue)
- CF120/99.0 (Light Green)
- CF120/102.0 (Light Yellow)
- CF120/105.0 (Light Purple)
- CF120/108.0 (Light Pink)
- CF120/111.0 (Light Blue)
- CF120/114.0 (Light Green)
- CF120/117.0 (Light Yellow)
- CF120/120.0 (Light Purple)
- CF120/123.0 (Light Pink)
- CF120/126.0 (Light Blue)
- CF120/129.0 (Light Green)
- CF120/132.0 (Light Yellow)
- CF120/135.0 (Light Purple)
- CF120/138.0 (Light Pink)
- CF120/141.0 (Light Blue)
- CF120/144.0 (Light Green)
- CF120/147.0 (Light Yellow)
- CF120/150.0 (Light Purple)

AVERAGE BEAM ANGLE (CF1) : 18.0°

Figure 10 consists of two plots. The left plot is a polar plot of the radiation pattern, showing the main lobe at 0 degrees and side lobes at approximately 30 and 60 degrees. The right plot is an elevation profile showing the radiation pattern in dB versus elevation angle. The profile has a main lobe at 0 degrees and side lobes at approximately 30 and 60 degrees.

Elevation Angle (deg)	Gain (dB)
0	13.0
30	11.0
60	10.0
90	9.0
120	8.0
150	7.0
180	6.0
210	5.0
240	4.0
270	3.0
300	2.0
330	1.0
360	0.0

Figure 10 consists of two plots. The left plot is a polar radiation pattern showing the main lobe and side lobes. The right plot is a cross-section of the beam profile showing the beam width and depth for different frequencies.

Left Plot: Radiation Pattern

The left plot is a polar radiation pattern showing the main lobe and side lobes. The main lobe is centered at 0 degrees. The side lobes are located at approximately 150, 180, and 210 degrees. The plot includes a legend for the main lobe and side lobes.

Right Plot: Beam Profile

The right plot is a cross-section of the beam profile showing the beam width and depth for different frequencies. The plot includes a legend for the beam width and depth for different frequencies.

Legend for Beam Profile:

Frequency (GHz)	Beam Width (mm)	Beam Depth (mm)
310	53.0	41.0
250	41.0	26.0
200	26.0	20.0
150	20.0	15.0
100	15.0	10.0

Figure 10 consists of two plots. The left plot is a polar plot showing the average beam profile in the horizontal plane. The radial axis represents distance in cm, ranging from 0 to 120. The angular axis represents the angle in degrees, ranging from -180 to 180. The plot shows several concentric rings and radial lines, indicating the beam's spread. The right plot is a 3D plot showing the average beam profile in the vertical plane. The vertical axis represents height in meters (m), ranging from 0 to 12. The horizontal axis represents radial distance in meters (m), ranging from 0 to 6. The plot shows several curved lines representing the beam's profile at different heights. A legend at the bottom of the 3D plot identifies the lines by color and height: 500, 800, 1000, 1200, 1400, 1600, 1800, 2000, 2200, 2400, 2600, 2800, 3000, 3200, 3400, 3600, 3800, 4000, 4200, 4400, 4600, 4800, 5000, 5200, 5400, 5600, 5800, 6000, 6200, 6400, 6600, 6800, 7000, 7200, 7400, 7600, 7800, 8000, 8200, 8400, 8600, 8800, 9000, 9200, 9400, 9600, 9800, 10000, 10200, 10400, 10600, 10800, 11000, 11200, 11400, 11600, 11800, 12000.

Figure 10 consists of two plots. The left plot is a polar plot of the C-plane input diagram (SWT) in dBm. The radial axis represents power in dBm, ranging from -120 to 0. The angular axis represents the beam angle in degrees, ranging from -135 to 135. The plot shows a central peak at 0 dBm, with a smaller peak at approximately 43.7 degrees. The average beam angle (SQA) is indicated as 43.7 degrees. The right plot is a C-plane input diagram (SWT) in dBm. The vertical axis represents power in dBm, ranging from -120 to 0. The horizontal axis represents the beam angle in degrees, ranging from -135 to 135. The plot shows a central peak at 0 dBm, with a smaller peak at approximately 43.7 degrees. The average beam angle (SQA) is indicated as 43.7 degrees. Both plots show the input power distribution for different beam angles (510, 430, 360, 260, 170 degrees) and the average beam angle (SQA) of 43.7 degrees.





FULL CONTROL

Start at the very beginning by figuring out what type of mounting you would like. Choose from a slim or broad shape. Options include in black or white. From there, you can also decide which baffle color suits your style, whether it's black, white, chrome or gold.

ORDERING GUIDE

Start at the very beginning by figuring out what type of mounting you would like. Choose from a slim or broad shape and the size you desire. Also, you can decide which baffle color suits your style, whether it's black, white, chrome or gold. From there, you can decide to use either black or white to match your decor.

1 This first step involves choosing your mounting

Choose:

Suspension | Surface Mount | Wall Mount

Suspension



Surface Mount



Wall Mount



2 Decide the size.

SLIM 8"



SLIM 13"



SLIM 18"



BROAD 6"



BROAD 10"



BROAD 18"



3 Connect!

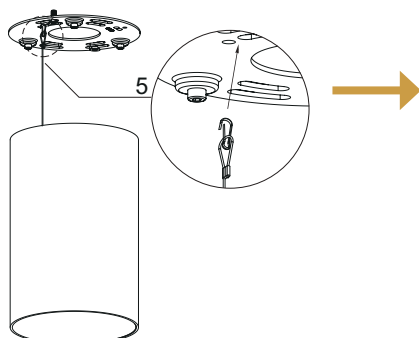

CONFIGURATOR

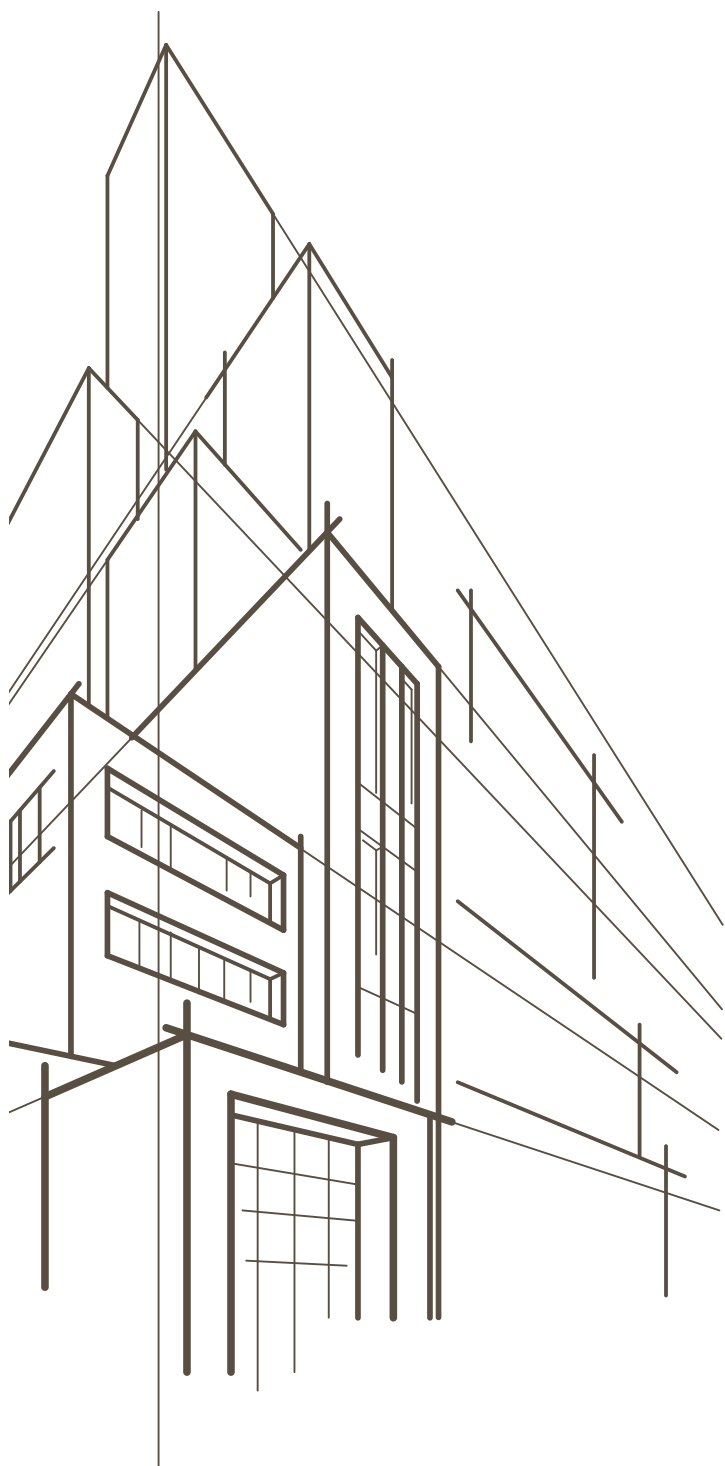

BEGIN BUILDING YOUR CONFIGURATION

PART A

Begin by choosing the mounting style and size to build your configuration. Design the aesthetics including the, light color and baffle color.

COMPLETE YOUR ORDER BY CHOOSING YOUR SPECIFICS

PART B

Finish your order by choosing the wattage, color temperature, beam angle, and the diffuser accessory.

COLLECTION (FAMILYNAME)	MOUNTING		COLOR		DIMENSIONS		BAFFLE COLOR	
WHS	SU	SUSPENSION	01	BLACK	SL8	2.5" X DIA X 8" HEIGHT	01	BLACK
	S	SURFACE MOUNT	02	WHITE	SL13	2.5" X DIA X 13" HEIGHT	02	WHITE
	W	WALL MOUNT			SL18	2.5" X DIA X 18" HEIGHT	03	CHROME
					BR6	4.5" X DIA X 6" HEIGHT	04	GOLD
					BR10	4.5" X DIA X 10" HEIGHT		
					BR18	4.5" X DIA X 18" HEIGHT		

WATT		CCT		BEAM ANGLE		DIFFUSER	
13	13W	27	2700K	N	15° NARROW	CL	CLEAR DIFFUSER
26	26W (BR ONLY)	30	3000K	M	24° MEDIUM	LN	LINEAR SPREAD DIFFUSER
		35	3500K	W	38° WIDE	FR	FROSTED DIFFUSER
		40	4000K			SP	SPREAD DIFFUSER
						HC	HONEYCOMB LOUVRE
						RE	RED DICHROIC
						GR	GREEN DICHROIC
						BL	BLUE DICHROIC
						OR	ORANGE DICHROIC

Fase¹_{TM}

33 West Beaver Creek Road,
Richmond Hill, Ontario Canada L4B 1L8

DALLAS TRADE MART
Eurofase Showroom, Suite #4002

tel 905.695.2055
fax 905.695.2056

toll free 1.800.660.5391
toll free 1.800.660.5390



Printed in Canada
© 2021 Eurofase Inc. All rights reserved.

Eurofase Inc. reserves the right to make alterations to the construction and design of products shown in this catalog in order to meet the laws or regulations of any authorized governing organization. The use of products shown in this catalog must comply with local building codes.